

VIIth. EUROPEAN CONGRESS OF PATHOLOGY



Valencia, Spain 17-21 September 1979

PROGRAMME

**VIIth CONGRESS OF
EUROPEAN SOCIETY OF PATHOLOGY**

17 - 21 SEPTEMBER 1979

*CONVENTION CENTER
ILUSTRE COLEGIO OFICIAL DE MÉDICOS
VALENCIA, SPAIN*

PRESIDENT

Professor C. Nezelof, France

This programme is sponsored by the A. E. C. C. of Valencia and the Fundación del Instituto Valenciano de Oncología.

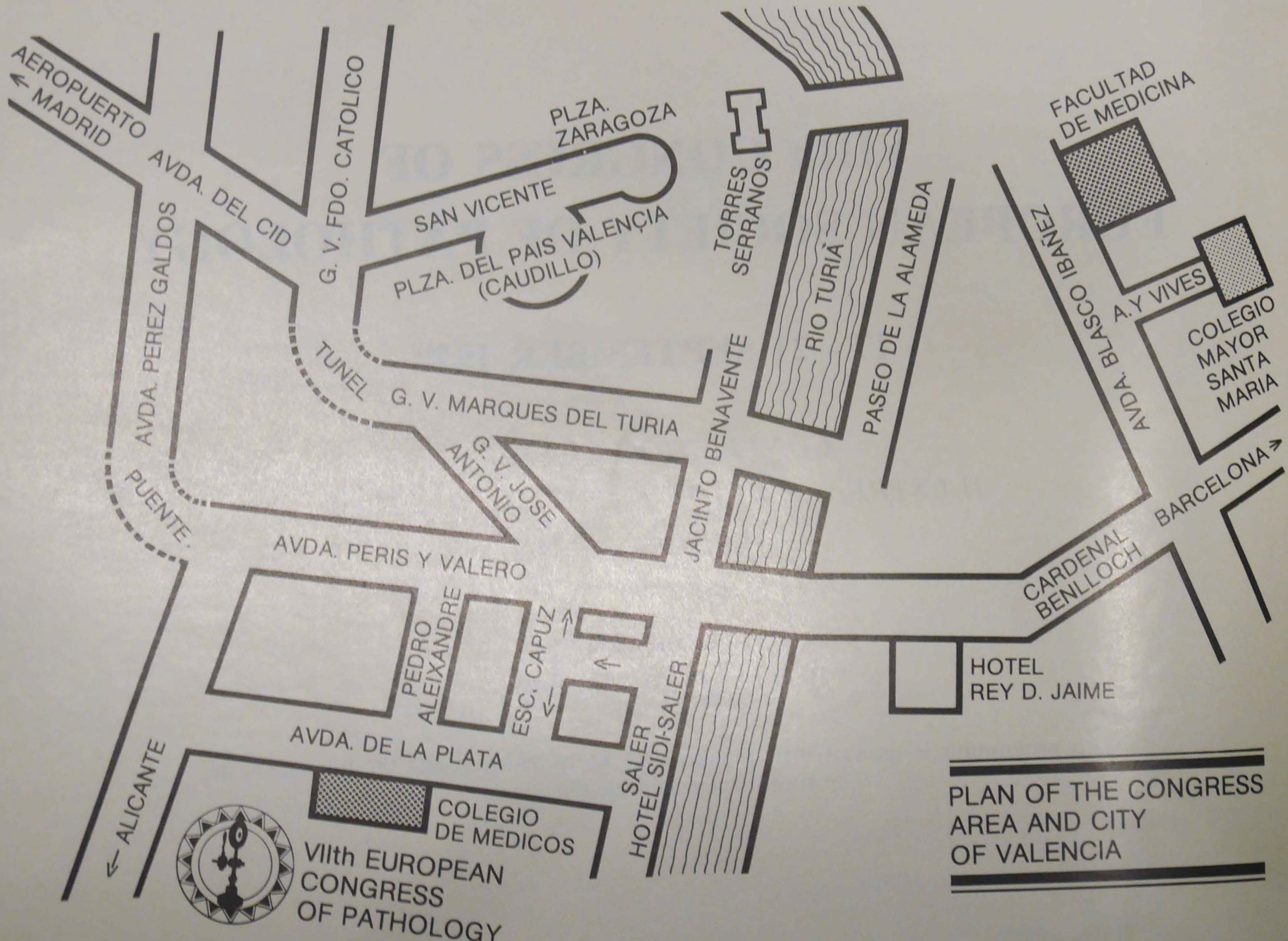

AEROPUERTO
← MADRID

AVDA. DEL CID

G. V. FDO. CATOLICO

PLZA. ZARAGOZA

SAN VICENTE

PLZA. DEL PAIS VALENCIA
(CAUDILLO)

TORRES SERRANOS

RIO TURIA

PASEO DE LA ALAMEDA

FACULTAD DE MEDICINA

AVDA. BLASCO IBANEZ

A. Y VIVES

COLEGIO MAYOR SANTA MARIA

TUNEL

G. V. MARQUES DEL TURIA

JACINTO BENAVENTE

G. V. JOSE ANTONIO

BARCELONA →

AVDA. PEREZ GALDOS

PUENTE

AVDA. PERIS Y VALERO

CARDENAL BENLLOCH

PEDRO ALEIXANDRE

ESC. CAPUZ

HOTEL REY D. JAIME

← ALICANTE

AVDA. DE LA PLATA

HOTEL SIDER-SALER



11th EUROPEAN CONGRESS OF PATHOLOGY

COLEGIO DE MEDICOS

PLAN OF THE CONGRESS AREA AND CITY OF VALENCIA

IX CONGRESO NACIONAL DE ANATOMÍA PATOLÓGICA

SOCIEDAD ESPAÑOLA DE ANATOMÍA PATOLÓGICA

PRESIDENTE

Profesor A. Llombart-Bosch

CONGRESS AREA: CONVENTION CENTER, ILUSTRE COLEGIO OFICIAL DE MÉDICOS

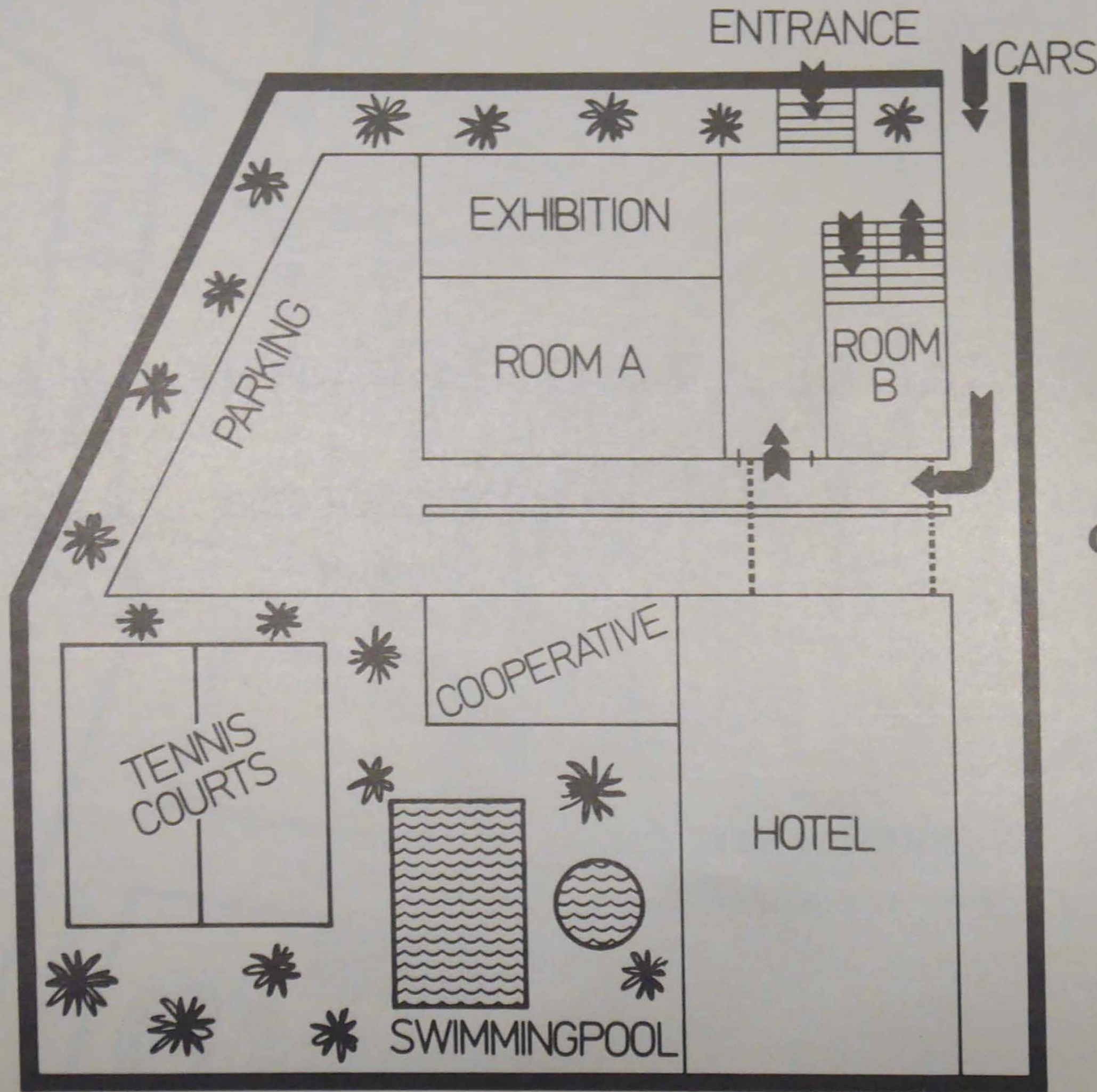

FIRST FLOOR

- SECRETARIAT
- VIAJES MELIÁ
- BANK
- MICROSCOPE ROOM
- BAR - RESTAURANT

GROUND FLOOR

BASEMENT

- ROOM C
- ROOM D
- GARAGE

INDEX

Message from the Patron	6
Patron, S.M. El Rey de España	7
Vice-Patrons	8
Honorary Committee	9
Executive and Honorary Committee of the European Society of Pathology	10
Organising Committees	11
Local Organising and Ladies's Committees	12
Message from the President	13
Scientific programme schedule	14
Scientific programme day by day	20
Monday	21
Tuesday	31
Wednesday	44
Thursday	50
Friday	62
Trade Exhibition	76
Social 'programme	77
General information	80



EL JEFE DE LA CASA DE
S. M. EL REY

ms 42/79

SU MAJESTAD EL REY, accediendo a la petición que tan amablemente Le ha sido formulada, ha tenido a bien aceptar el

ALTO PATRONAZGO

del VII CONGRESO EUROPEO DE PATOLOGIA, que se ha de celebrar en VALENCIA.

Lo que me complace comunicarle para su conocimiento y efectos.

LA ZARZUELA, 13 de febrero de 1979

EL JEFE DE LA CASA DE S. M. EL REY,

El Marqués de la Guardia

PATRON: S. M. EL REY DE ESPAÑA, JUAN CARLOS I

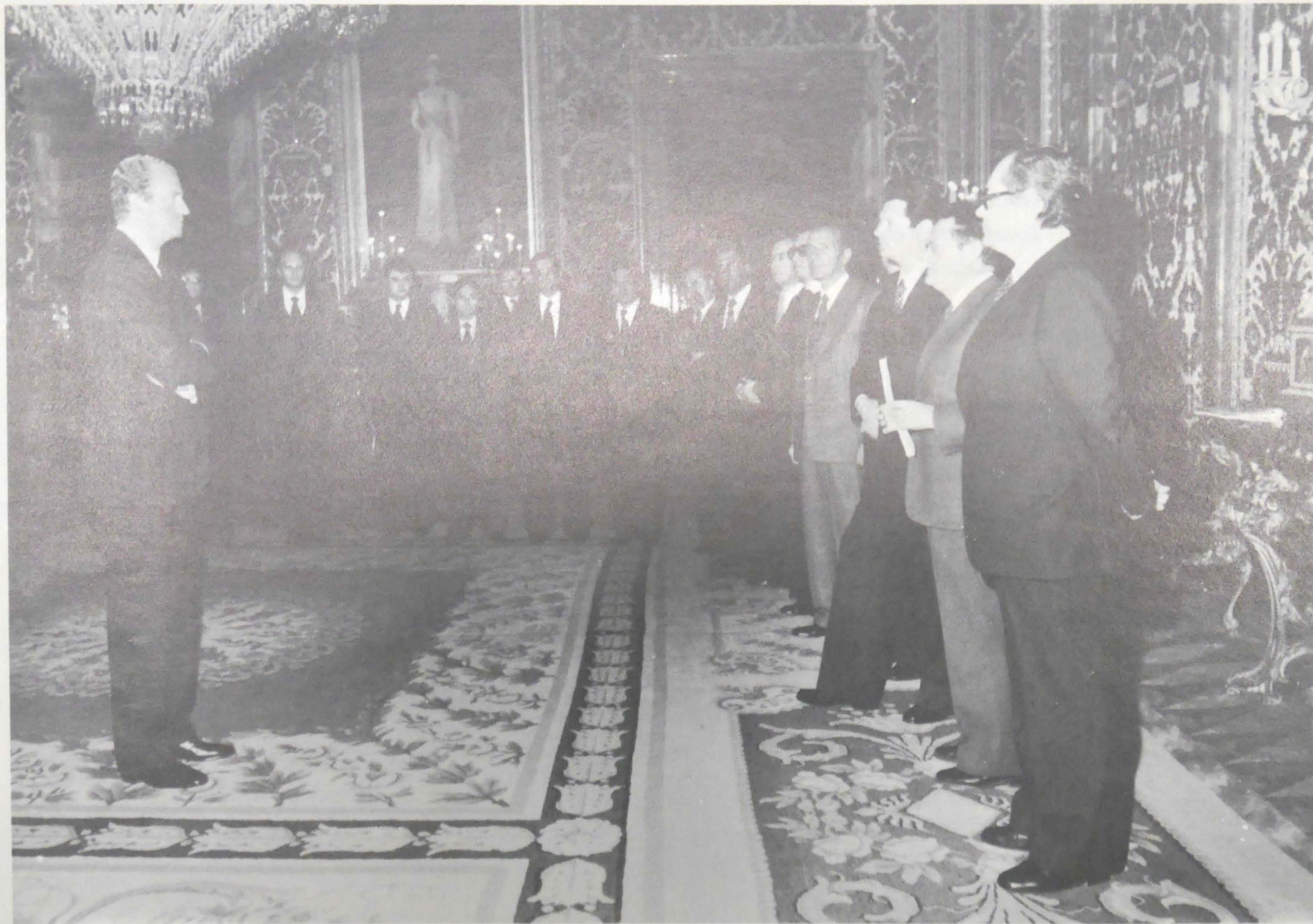

VICE-PATRONS

Vicepresidente 2.º del Gobierno: **Excmo. Sr. D. Fernando Abril Martorell**

Ministro de Universidades e Investigación: **Excmo. Sr. D. Luis González Seara**

Ministro de Asuntos Exteriores: **Excmo. Sr. D. Marcelino Oreja Aguirre**

Ministro de Comercio y Turismo: **Excmo. Sr. D. Juan Antonio García Díez**

Ministro de Cultura: **Excmo. Sr. D. Manuel Clavero Arévalo**

Ministro de Sanidad y Seguridad Social: **Excmo. Sr. D. Juan Rovira Tarazona**

Secretario de Estado para Sanidad: **Excmo. Sr. D. José M.^a Segovia de Arana**

Subsecretario de Universidades e Investigación: **Excmo. Sr. D. Manuel Cobo del Rosal**

Director General de Universidades: **Ilmo. Sr. D. Vicente Gandía Gomar**

Director General de Salud: **Ilmo. Sr. D. Luis Valenciano Clavel**

Director General de Difusión Cultural: **Ilmo. Sr. D. Eduardo Ballester Giner**

Subdirector General del 3.º ciclo: **Ilmo. Sr. D. Javier García-Conde Bru.**

Presidente del Consell del País Valencià: **Excmo. Sr. D. José Luis Albiñana**

Presidente de la Audiencia Territorial de Valencia: **Excmo. Sr. D. Carmelo Quintana Redondo**

Presidente de la Asociación Española contra el Cáncer: **Excmo. Sr. D. Iñigo de Arteaga, Duque del Infantado.**

HONORARY COMMITTEE

Capitán General de la 3.^a Región Militar: Excmo. Sr. D. Jaime Milans del Bosch y Ussía

Gobernador Civil: Excmo. Sr. D. José M.^a Fernández del Río y Fernández.

Rector de la Universidad: Excmo. Sr. D. Joaquín Colomer Sala.

Presidente de la Diputación: Excmo. Sr. D. Manuel Girona Rubio.

Alcalde de Valencia: Excmo. Sr. D. Fernando Martínez Castellano.

Delegado Territorial de Sanidad: Ilmo. Sr. D. Francisco Giner Baixauli.

Delegado Provincial de Turismo: Ilmo. Sr. D. Julio Doblado Claverie.

Delegado Provincial de Cultura: Ilmo. Sr. D. Juan Marco Molines.

Decano Facultad Medicina: Ilmo. Sr. D. Francisco Gomar Guarner.

Presidente Real Academia de Medicina: Ilmo. Sr. D. Francisco Javier García-Conde.

Presidente del Colegio de Médicos: Ilmo. Sr. D. Vicente Tormo Alfonso.

Director del Museo de Bellas Artes y del Nacional de Cerámica: Ilmo. Sr. D. Felipe Garín-Llombart.

Presidente de la Junta Provincial de la Asociación Española contra el Cáncer de Valencia: Ilmo. Sr. D. Tomás Trénor
de Azcárraga, Marqués del Turia.

Presidente de la Fundación del Instituto Valenciano de Oncología (I.V.O.): Ilmo. Sr. D. Antonio Llombart-Rodríguez.

Alcalde de Peñíscola: Ilmo. Sr. D. Ramón Rovira Pauner.

Alcalde de Sagunto: Ilmo. Sr. D. Manuel Carbó Juan.

**HONORARY COMMITTEE
EUROPEAN SOCIETY
OF PATHOLOGY**

Professor F. Cabanne, France
Professor P. Dustin, Belgium
Professor J. Groniowski, Poland
Professor J. H. Holzner, Austria
Professor H. Jellinek, Hungary
Professor Piringer-Kutchinka, Austria

**EXECUTIVE COMMITTEE
OF THE EUROPEAN SOCIETY
OF PATHOLOGY**

<i>President</i>	Professor C. Nezelof, France
<i>Vice-President</i>	Professor J. Groniowski, Poland
<i>Secretary</i>	Professor A. Giordano, Italy
<i>Treasurer</i>	Professor G. J. V. Swaen, The Netherlands
<i>Advisers</i>	Professor P. Dustin, Belgium Professor E. Grundmann, F. R. G. Professor J. H. Holzner, Austria Dr. J. V. Johannessen, Norway

ORGANISING COMMITTEES

SOCIEDAD ESPAÑOLA DE ANATOMÍA PATOLÓGICA

President: Prof. A. Llombart-Bosch (Valencia)
Vice-President: Dr. F. Contreras-Rubio (Madrid)
Secretary: Dr. V. Navarro-Berastegui (Madrid)

DIVISIÓN ESPAÑOLA DE LA ACADEMIA INTERNACIONAL DE PATOLOGÍA

Presidente: Dr. L. Galindo-Merino (Barcelona)
Vice-President: Dr. Martínez-Tello (Madrid)
Secretary: Dr. R. Martínez-Cabruja (Madrid)

Advisers: Dr. L. Capote de Armas (Madrid)
Dr. G. García-Julián (Zaragoza)
Dr. J. M. Loizaga-Iriondo (Sevilla)
Prof. G. Ortuño-Pachecho (Murcia)
Dr. J. Pérez-Villanueva (Vigo)
Dr. S. Ramón y Cajal (Madrid)
Dr. A. Santos-Briz (Salamanca)

LOCAL ORGANISING COMMITTEE

Prof. A. Llombart-Bosch
Prof. A. Peydró-Olaya
Prof. J. Colomer-Sala
Prof. R. Báguena-Candela
Prof. J. M. López-Piñeiro
Prof. A. Barberá-Guillén

and

Staff of the Department of Pathology, Valencia Medical School

LADIES' COMMITTEE

D.^a Nadine Cussac de Llombart
D.^a Pura N. de Galindo
D.^a Alicia Mejuto de Contreras
D.^a Demetra Rigopoulou de Martínez-Tello
D.^a Margarita Stingel de Von Schilling

MESSAGE FROM THE PRESIDENT

A hearty welcome to seventh Congress of European Society of Pathology!

The first meeting of our Society in the Iberic region. This Congress will certainly highlights both our Society and spanish pathology.

It is my privilege to express my sincere thanks to the local committee of organisation and to the Spanish Society of Pathology for their interest and efforts in preparing this meeting.

The scientific program including 5 Plenary Sessions, 4 scientific sessions, 3 short courses, 9 slide seminars and a Symposium is very attractive and meets to a great extent the goals of the European Society of Pathology: promotion of research, improvement of methods in diagnosis and teaching, illuminating new areas in pathology.

While considering the number of participants, the names of our distinguished Hispanic and Portuguese colleagues and the personality of internationally recognized pathologists. I am already assured that this congress will be a great success in the traditional line of the congresses of our Society. I am sure your participation will be scientifically rewarding and socialy enjoyable and I extend my wishes for or pleasant stay.

Christian NEZELOF

*President of European Society
of Pathology.*

SCIENTIFIC PROGRAMME SCHEDULE

SUNDAY 16 SEPTEMBER

15,00 - 19,30 **Registration** Hall of the Convention Center Secretariat 1st floor

ROOM A

ROOM B

MONDAY 17 SEPTEMBER

09,00 - 09,15 Opening Ceremony

09,15 - 10,00 Symeonidis Lecture

11,00 - 13,30 Plenary Session
PATHOLOGY OF THE INTERPHASE
NUCLEUS

14,30 - 16,30 Slide Seminar
NEONATAL PATHOLOGY

16,45 - 18,45 Slide Seminar
GYNECOLOGIC PATHOLOGY

10,30 - 13,30 Short Course 5. 1
VALUE OF ELECTRON MICROSCOPY
IN DIAGNOSTIC PATHOLOGY

14,30 - 18,15 Scientific Session
TISSUE CULTURE IN THE STUDY
OF TUMORS.

ROOM C

11,45 - 13,00 Free Paper Session 1
EXPERIMENTAL PATHOLOGY I

14,30 - 16,30 Free Paper Session 2
NEUROPATHOLOGY

16,45 - 18,30 Free Paper Session 3
EXPERIMENTAL PATHOLOGY II

ROOM D

14,30 - 16,30 Free Paper Session 4
CARDIOVASCULAR DISEASE I

16,45 - 18,30 Free Paper Session 5
CARDIOVASCULAR DISEASE II

ROOM A

ROOM B

TUESDAY 18 SEPTEMBER

- 09,00 - 13,00 Plenary Session
MONONUCLEAR PHAGOCYTES AND
HISTIOCYTES IN DISEASE
- 14,00 - 16,00 Slide Seminar
NEUROPATHOLOGY AND
NEUROMUSCULAR DISORDERS
- 16,15 - 18,15 Slide Seminar
DERMATOPATHOLOGY

- 09,00 - 10,45 Free Paper Session 6
DERMATOPHATOLOGY I
- 11,00 - 12,45 Free Paper Session 7
DERMATOPATHOLOGY II
- 14,00 - 17,45 Scientific Session
PSEUDOTUMORAL AND REACTIVE
LYMPHOID DISORDERS

WEDNESDAY 19 SEPTEMBER

IX CONGRESO NACIONAL DE ANATOMÍA PATOLÓGICA

- 09,00 - 13,00 Plenary Session
ENDOSCOPIC PATHOLOGY OF THE
GASTRO INTESTINAL TRACT
- 14,00 - 16,00 Slide Seminar
NON-TUMORAL DISORDERS
OF THE LIVER
- 16,15 - 18,15 Short Course
SOFT TISSUE TUMORS

- 14,00 - 16,00 Short Course
METABOLIC DISEASE OF BONE
TISSUE

ROOM C

09,00 - 11,00 Free Paper Session 8
LIVER DISEASE I

14,00 - 16,00 Free Paper Session 10
LIVER DISEASE III

16,15 - 18,00 Free Paper Session 11
MISCELLANEOUS:
EXPERIMENTAL PATHOLOGY

14,00 - 16,00 Free Paper Session 16
GASTROINTESTINAL DISEASE I

16,15 - 18,15 Free Paper Session 17
GASTROINTESTINAL DISEASE II

ROOM D

09,00 - 11,00 Free Paper Session 12
BONE TUMORS

14,00 - 15,45 Free Paper Session 14
FEMALE GENITAL DISEASE I

16,15 - 17,45 Free Paper Session 15
FEMALE GENITAL DISEASE II

14,00 - 16,00 Free Paper Session 18
ENDOCRINOLOGY I

16,15 - 18,30 Free Paper Session 19
BREAST DISEASE

ROOM A**ROOM B***THURSDAY 20 SEPTEMBER*

- 09,00 - 13,00 Plenary Session
GERM CELL TUMORS
- 14,00 - 16,00 Slide Seminar
HEMATOPHATOLOGY
- 16,15 - 18,15 Slide Seminar
BONE TUMORS
- 18,30 GENERAL ASSEMBLY OF THE
EUROPEAN SOCIETY OF PATHOLOGY

- 09,00 - 13,00 Symposium
TRAINING PROGRAMMES IN
PATHOLOGY
- 14,00 - 17,45 Scientific Session
CHEMICAL
NEUROCARCINOGENESIS

FRIDAY 21 SEPTEMBER

- 09,00 - 13,00 Plenary Session
THYROID GLAND PATHOLOGY
- 14,00 - 16,00 Slide Seminar
ORAL PATHOLOGY
- 16,15 - 18,15 Slide Seminar
PROBLEMS IN DIAGNOSTIC
SURGICAL PATHOLOGY
- 18,30 GENERAL ASSEMBLY OF THE
SPANISH SOCIETY OF PATHOLOGY

- 09,00 - 13,00 Workshop
CLINICAL CYTOPATHOLOGY
- 14,00 - 17,45 Scientific Session
LUNG PATHOLOGY IN INTENSIVE
CARE UNITS

ROOM C

- 09,00 - 11,00 Free Paper Session 20
KIDNEY DISEASE I
- 11,15 - 13,00 Free Paper Session 21
KIDNEY DISEASE II
- 14,00 - 16,00 Free Paper Session 22
GENITOURINARY DISEASE
- 16,15 - 18,15 Free Paper Session 23
ENDOCRINOLOGY II

ROOM D

- 09,00 - 10,45 Free Paper Session 24
LUNG TUMORS
- 11,00 - 13,00 Free Paper Session 25
LUNG DISEASE
- 14,00 - 16,00 Free Paper Session 26
GERM CELL TUMORS
- 16,15 - 18,00 Free Paper Session 27
FEMALE GENITAL DISEASE III

-
- 09,00 - 11,00 Free Paper Session 28
CHILDHOOD DISEASE I
- 11,15 - 13,00 Free Paper Session 29
CHILDHOOD DISEASE II
- 14,00 - 16,15 Free Paper Session 30
CHILDHOOD DISEASE III
- 16,30 - 18,30 Free Paper Session 31
SOFT TISSUE TUMORS

- 09,00 - 11,00 Free Paper Session 32
LYMPHOMAS I
- 11,15 - 13,00 Free Paper Session 33
LYMPHOMAS II
- 14,00 - 16,00 Free Paper Session 34
LYMPHOID AND MACROPHAGE
DISEASE I
- 16,15 - 18,30 Free Paper Session 35
LYMPHOID AND MACROPHAGE
DISEASE II

**SCIENTIFIC
PROGRAMME
DAY BY DAY**

MONDAY SEPTEMBER 17, 1979

09,00 - 10 hrs.

ROOM A

09,00 - 09,15 **OPENING CEREMONY**

Welcoming Addresses:

Prof. Dr. **A. Llombart-Bosch.**

President of the Organising Committee of the VIIth European Congress of Pathology and IX Congreso Nacional de Anatomía Patológica.

Prof. Dr. **C. Nezelof**

President of the European Society of Pathology.

Prof. Dr. **V. Tormo**

President of Valencia's Medical Association (Ilustre Colegio Oficial de Médicos)

09,15 - 10,00 **SYMEONIDIS LECTURE**

Guest Lecture: **S. Grisolia** (Valencia, Spain).

001 Mitochondrial Protein Degradation

S. Grisolia, E. Knecht, J. Hernandez, A. Martínez, V. Rubio, R. Wallace (Instituto de Investigaciones Citológicas. Valencia, Spain)

MONDAY SEPTEMBER 17, 1979

11,00 - 13,30 hrs.

ROOM A

11,00 - 13,30 **PLENARY SESSION**

PATHOLOGY OF THE INTERPHASE NUCLEUS

Chairman: M. Bouteille (Paris, France)
Co Chairman: W. Sandritter (Freiburg, Germany)

FR. HAGUENAU (Collège de France, Paris, France)

002 In memory of Prof. Bernhard.

M. BOUTEILLE (Laboratoire Pathologie Cellulaire, Université Curie, Paris, France)

003 Nucleo-cytoplasmic correlations in nuclear transcription.

W. SANDRITTER (Department of Pathology, University, Freiburg, Germany).

004 Cytophotometric measurements in normal and malignant cells.

A. GIORDANO (Istituto Anatomia Istologia Patologica, Milano, Italy)

005 Cytogenetics of tumoral cell nuclei in interphase.

E. BARBERA, A. PEYDRO—OLAYA, A. LLOMBART-BOSCH (Department of Pathology, Hospital Clinico Universitario, Medical School, Valencia, Spain).

006 Modifications of chromatine quality in malignant cell transformation.

10,30 - 13,30 **SHORT COURSE:**

THE VALUE OF ELECTRON MICROSCOPY IN DIAGNOSTIC PATHOLOGY

Chairman: J. V. Johannessen (Oslo, Norway)

Speakers:

J. V. JOHANNESSEN (Laboratory for Ultrastructural Pathology, Department of Pathology, The Norwegian Radium Hospital and Norsk Hydros Institute for Cancer Research. Montebello, Oslo 3, Norway)

T. APARISI (Department of Orthopedic Surgery, Karolinska Hospital. Stockholm, Sweden).

J. DARÓCZY (Electron Microscopic Laboratory, Dermatology Clinic of Budapest, Semmelweis Medical University. Budapest, Hungary.)

G. DHOM (Institute of Pathology, Saarlandes University. Homburg-Saar, Germany.)

V. E. GOULD (Department of Pathology, Rush Medical College. Chicago, USA.)

K. LAPIS (Institute of Pathology. Semmelweis Medical University. Budapest, Hungary.)

H. P. ROHR (Institute of Pathology, University of Basel, Switzerland.)

J. ROSAI (Department of Laboratory Medicine and Pathology, Medical School, University of Minnesota, Minneapolis, Minnesota, USA.)

H. J. SOBEL (Department of Pathology, Veterans Administration Hospital. East Orange, USA.)

H. U. ZOLLINGER (Institute of Pathology, University of Basel, Switzerland.)

FREE PAPER SESSION 1: EXPERIMENTAL PATHOLOGY I

Chairman: J. J. Vázquez (Spain)

Co Chairman: F. Wenger (Venezuela)

11,45 - 12,00 **F. J. PARDO-MINDAN, M. SANTAMARÍA, N. G. A. PICARDO, M. MESTRES, J. J. VÁZQUEZ**

(Department of Pathology, Faculty of Medicine, Pamplona, Spain.)

091 Eosinophilic inflammation of specific organs, not associated with known allergic states.

12,00 - 12,15 **A. BLANES, A. MARTÍNEZ, S. RAMON Y CAJAL JR.** (Dpts. Anat. Patol., Colegio Univ., División

Medicina de Las Palmas and Fctad. Medicina Univ. Complutense de Madrid, Spain.)

092 Morphological changes in the small intestinal mucosae after induction of hypothyroidism in the adult rat.

12,15 - 12,30 **J. LIBERT, P. KETELBANT-BALASSE, F. VAN HOOFF** (Brussels, Belgium).

093 Ultrastructural studies of the lysosomal storage induced by aminoglycosides in vivo.

12,30 - 12,45 **F. WENGER, H. DE RODRÍGUEZ** (Maracaibo, Venezuela South America).

094 Interference contrast microscopy used for studying tissues especially retina.

12,45 - 13,00 **M. MERCHAN, M. LUDENA, J. MERCHAN, P. ARAGONCILLO, J. FARIÑA** (Madrid, Spain).

095 About the deciliation mechanism of the organ of Corti under the toxical effect of kanamycin.

MONDAY SEPTEMBER 17, 1979

14,30 - 18,45 hrs.

ROOM A

14,30 - 16,30 SLIDE SEMINAR ON NEONATAL PATHOLOGY

Coordinator: **A. MORAGAS** (Departments of Pathology, Ciudad Sanitaria "Francisco Franco" and Autonomus University, Barcelona, Spain).

Rapporteurs: **J. L. EMERY** (Department of Pathology, Children's Hospital, Sheffield, England).

F. GONZÁLEZ-CRUSSI (Department of Pathology, Indiana University School of Medicine, Indianapolis, Indiana, USA).

16,45 - 18,45 SLIDE SEMINAR ON GYNECOLOGIC PATHOLOGY

Coordinators: **F. NOGALES** (Department of Pathology, Hospital Clinico Universitario, Medical School, Sevilla, Spain).

J. PRAT (Department of Pathology, Massachusetts General Hospital, Harvard Medical School, Boston, USA).

Rapporteurs: **H. FOX** (Department of Pathology, University of Manchester, England).

F. NOGALES ORTIZ (Department of Gynecologic Pathology, Hospital Clínico Universitario, Madrid, Spain).

R. E. SCULLY (Department of Pathology, Massachusetts General Hospital, Harvard Medical School, Boston, USA).

14,30 - 18,15 **SCIENTIFIC SESSION**

TISSUE CULTURE IN THE STUDY OF TUMORS

Chairman: J. Escalona (Madrid, Spain).

Co Chairman: L. Ozello (Lausanne, Switzerland).

J. ESCALONA (Ciudad Sanitaria Prov. Fco. Franco, Madrid, Spain).

039 Cytology and growth pattern of fibrosarcoma and related tumors.

L. OZELLO (Institute of Pathology. Medical School, Lausanne, Switzerland).

040 Tissue culture of muscle tumors.

M. D. DIEZ-NAU (Ciudad Sanitaria Prov. Fco. Franco, Madrid, Spain).

041 Some aspects of bone tumors in tissue culture.

E. ÁLVAREZ (Ciudad Sanitaria Prov. Fco. Franco, Madrid, Spain).

042 Tumours of blood vessels and of the mesothelial coverlayers.

H. CRAVIOTO, V. DEFENDI (Department of Pathology, New York University Medical Center, New York, USA.)

043 Human meningiomas in tissue culture.

M. D. DIEZ-NAU (Ciudad Sanitaria Prov. Fco. Franco, Madrid, Spain).

044 Neurinomas.

J. ESCALONA (Ciudad Sanitaria Prov. Fco. Franco, Madrid, Spain).

045 Brain astrocytomas and their derivatives.

F. GULLOTTA (Institut für Neuropathologie der Universtät, Bonn, Germany).

046 Tissue cultures of cerebellar tumors.

E. BRONZINI (Ospedali Galliera, Genova, Italy).

047 Value of tissue culture in the diagnosis of intracranial tumours.

J. SUGAR, I. PALYI (Research Institute of Oncopathology, Budapest, Hungary).

048 Characteristics of human lymphoblastoid cell lines established in culture.

O. FERRER-ROCA (Department of Pathology, Faculty of Medicine, University of Barcelona, Spain).

049 Clonal evolution of goitres.

M. F. ROUSSEAU-MERCK, C. NEZELOF (Laboratoire de Pathologie Pédiatrique, Hopital Necker, Paris, France).

050 Organ culture in the study of humans tumours with special reference to nephroblastoma.

L. VALENCIANO (Madrid, Spain).

051 Cell changes by carcinogenic virus in vitro.

FREE PAPER SESSION 2: NEUROPATHOLOGY

Chairman: W. Jänisch (DDR).

Co Chairman: J. L. Sarasa (Spain).

- 14,30 - 14,45 **I. FERRER, J. SARMIENTO** (Barcelona, Spain).
096 Nascent microglia in the developing rat brain.
- 14,45 - 15,00 **M. GUTIÉRREZ MOLINA, C. MORALES BASTOS, C. HIDALGO LOZANO** (Madrid, Spain).
097 Pathological considerations about two infrequent cases: 1.—Sudanophilic leucoencephalopathy combined with microencephaly, cerebellar congenital granular layer atrophy and partial callosal agenesis. 2.—Lissencephaly and cerebellar aplasia.
- 15,00 - 15,15 **J. IGLESIAS, J. GUTIÉRREZ, A. CÓRDOBA** (Madrid, Spain).
098 Microangio-architecture of the cerebral cortex during chronic hypertension in man.
- 15,15 - 15,30 **R. CHOUX, J. HASSOUN, M. TOGA** (Marseille, France).
099 Intra-cerebral germinomas. Light and electron microscopy study.
- 15,30 - 15,45 **J. L. SARASA, R. GARCÍA GONZÁLEZ** (Dpto. de Patología, Fundación Jiménez Díaz, Madrid, Spain).
100 Ultrastructure of ependymomas of infant posterior fossa.
- 15,45 - 16,00 **D. SCHREIBER, W. JÄNISCH** (Institute of Pathology, Medical Academy, Erfurt, DDR).
101 Brain tumors in early life.
- 16,00 - 16,15 **W. JÄNISCH, F. W. RATH, D. FELICETTI** (Pathologisches Institut, Halle, Germany).
102 Early stages of experimental brain tumors.
- 16,15 - 16,30 **H. D. MENNEL** (Neurologisches Klinik, Köln, Germany).
103 Morphology of experimental central nervous system tumors with special reference to comparative aspect in the human.

FREE PAPER SESSION 3: EXPERIMENTAL PATHOLOGY II

Chairman: J. Sanz Esponera (Spain).
Co Chairman: O. Stutman (USA).

- 16,45 - 17,00 **J. LÁZARO PÉREZ, J. SANZ ESPONERA, M. RUBIO NÁCHER** (Hospital Clínico Universitario, Zaragoza, Spain).
104 Experimental tumours in rats bladders. A comparative study with humans.
- 17,00 - 17,15 **K. H. HOLLMANN, J. M. VERLEY** (Hopital Marie Lannelongue, Le Plessis Robinson, France).
105 Histo- and cytomorphology of res in mammary tumor-bearing rats following local or systemic immunostimulation.
- 17,15 - 17,30 **O. STUTMAN** (Memorial Sloan-Kettering Cancer Center, New York, USA).
106 Transplacental carcinogenesis in athymic nude mice.
- 17,30 - 17,45 **T. ÁLVAREZ GAGO, A. CARDESA, J. J. MATEOS, F. POTT, K. H. FRIEDRICHS, U. MOHR** (Departamento de Anatomía Patológica, Facultad de Medicina, Valladolid, Spain).
107 Early mesothelial lesions associated to experimental mesotheliomas of the peritoneum.
- 17,45 - 18,00 **K. PERK** (Head Department of Animal Sciences, Hebrew University of Jerusalem, Rehovot Campus, Rehovot, Israel).
108 Presence of leukemic clusters in the meninges of animals.
- 18,00 - 18,15 **P. ARAGONCILLO, A. SUÁREZ, F. FARIÑA, F. LLANES, O. RAMÍREZ** (Hospital Clínico de San Carlos, Madrid, Spain).
109 Morphology of experimental pulmonary allograft with azathioprine and methylprednisolone.
- 18.15 - 18,30 **B. C. GHOSH, L. GHOSH, T. K. DAS GUPTA** (Departments of Surgery and Pathology, Abraham Lincoln School of Medicine University Chicago, Illinois, USA.).
110 Ontogeny of lactic dehydrogenase and its relation to chemically induced mouse lung cancer.

FREE PAPER SESSION 4: CARDIOVASCULAR DISEASE I

Chairman: H. David (DDR).

Co Chairman: F. Llanes (Spain).

- 14,30 - 14,45 **I. RIESGO, J. GARCÍA, A. ORDUÑA** (Oviedo, Spain).
111 Hipereosinophilic syndrome with endomyocardic fibrosis (A case report).
- 14,45 - 15,00 **B. C. ANESTIADIS, B. B. ANESTIADIS** (Kishinev, URSS).
112 Fluorescence changes produced by an infarct in the residual myocardial tissue.
- 15,00 - 15,15 **S. STERNBERG**, (Memorial Hospital, New York, USA).
113 Anthracycline cardiotoxicity. Unusual pathological changes with special reference to endomyocardial fibrosis, trombosis and myocardial infarction.
- 15,15 - 15,30 **J. ORTEGO, F. DE RETANA, J. SANZ ESPONERA, M. MOROS GARCÍA** (Hospital Clínico Universitario, Zaragoza, Spain).
114 Idiopathic congestive cardiomyopathy. An optic and electron microscopy study.
- 15,30 - 15,45 **D. LAKY, G. FILIPESCU, SM. CONSTANTINESCU, FL. HALALAU, N. M. CONSTANTINESCU** (Victor Babes Institute, Bucharest, Romania).
115 Electronmicroscopic and biochemical researches in experimental transitory myocardial ischaemia.
- 15,45 - 16,00 **K. KUBAT, Z. TUREK, B. E. M. RINGNALDA, F. KREUZER**
(Departments Pathol. and Physiol., Fac. Med., University of Nijmegen, Nijmegen, The Netherlands).
116 Experimental cardiac necrosis in rats acclimated to simulated high altitude.
- 16,00 - 16,15 **H. DAVID** (Inst. of Path. Humboldt Univ., Berlin, Germany)
117 The postnatal development of mitochondria of heart muscle cells of rats.
- 16,15 - 16,30 **F. LLANES, P. ARAGONCILLO, C. PÉREZ ROBLEDO, A. PELAYO, J. FARIÑA**
(Hospital Clínico de San Carlos, Madrid, Spain).
118 Experimental cimetidine-induced heart alterations.

MONDAY SEPTEMBER 17, 1979

16,45 - 18,30 hrs.

ROOM D

FREE PAPER SESSION 5: CARDIOVASCULAR DISEASE II

Chairman: J. Fariña (Spain).

Co Chairman: F. Zak (Switzerland).

- 16,45 - 17,00 **A. M. TOSZEGI, G. KOVACS** (Department of Pathol. and I. Surgical Clinic, Medical Univ. Szeged, Hungary).
119 Pathomechanism of deterioration of the Cross Jones heart valve prostheses.
- 17,00 - 17,15 **J. FARIÑA, D. LUDENA, P. ARAGONCILLO, M. MERCHAN, C. BAÑUELOS** (Madrid, Spain).
120 Morphology of the flopping valve.
- 17,15 - 17,30 **H. R. WEIDENBACH, A. HECHT** (Pathol. Institut, Leipzig, DDR).
121 Cellular changes of arterial smooth muscle cells during regression phase of experimental atherosclerosis.
- 17,30 - 17,45 **M. ARTEAGA, M. V. DE LA CRUZ, R. FERNÁNDEZ ESPINO** (Centro Especial Ramón y Cajal, Madrid, Spain).
122 Partial distortion of the great arteries. Embryogenesis, pathology and classification.
- 17,45 - 18,00 **M. L. MATOS BEJA** (Facultad de Medicina, Coimbra, Portugal)
123 Aortic Microangiopathy.
- 18,00 - 18,15 **F. ZAK, N. ZAKOVA, R. HESS** (Departments of Toxicology, Pathology, Ciba-Geigy Ltd., Basle, Switzerland).
124 Benign and malignant tumours of vascular origin in mag mice.
- 18,15 - 18,30 **U. BONK** (Department of Pathology, Bremen-North, Germany).
125 Status of the autopsy.

MONONUCLEAR PHAGOCYTES AND HISTIOCYTES IN DISEASES

Chairman: K. Lennert (Kiel, Germany).

Co-Chairman: C. Nezelof (Paris, France).

R. VAN FURTH (Department of Infectious Diseases, University Hospital, Leyden, The Netherlands).

007 Origin and kinetics of mononuclear phagocytes.

H. K. MÜLLER-HERMELINK, E. KAISERLING (Institute of Pathology, University of Kiel, Germany).

008 Reticulum cells of human lymphoid tissue: micro-ecological concept of tissue organization in health and disease.

J. GRONIEWSKI, M. WALSKI (Warsaw, Poland).

009 Pulmonary alveolar macrophage. Electron microscopy studies.

P. RACZ, K. TENNER-RACZ (Bernhard-Nocht Institute, Hamburg, Germany).

010 Macrophages in diseases caused by facultative intracellular bacteria.

F. RILKE (Istituto Nazionale Tumori, Milano, Italy).

011 Malignant histiocytosis.

C. NEZELOF, S. BARBEY, F. JAUBERT, C. NOGUES, M. F. MERCK (Groupe de Pathologie Pédiatrique, Hôpital Necker, Paris, France).

012 Histiocytosis X. Histogenesis.

K. LENNERT (Institute of Pathology, University of Kiel, Germany).

013 Pseudo-tumoral proliferations.

FREE PAPER SESSION 6: DERMATOPATHOLOGY I

Chairman: V. J. Mc Govern (Australia).

Co Chairman: J. Calap (Spain).

- 09,00 - 09,15 **A. MORENO CARAZO, J. AUTONELL REIXACH, C. MARQUÉS CARDELL** (Barcelona, Spain).
126 Acral lentiginous malignant melanoma.
- 09,15 - 09,30 **R.R. PALADUGU** (City of Hope Medical Center, Duarte, California, (U. S. A.)
127 Biologic behavior of "thin" malignant melanomas.
- 09,30 - 09,45 **V. J. McGOVERN, H. SHAW, G. MILTON, G. FARAGO** (Royal Prince Alfred Hospital, Camperdown
Australia).
128 Prognostic indicators in melanoma.
- 09,45 - 10,00 **J. G. TANAGO, J. M. YÁNEZ, L. FEIJÓO, J. M. RIVERA-POMAR** (Algorta, Vizcaya, Spain).
129 Recidiving melanotic neuroectodermal tumor of the forearm. Ultrastructural aspects.
- 10,00 - 10,15 **J. COSTA, M. POPOVSKY** (National Cancer Institute, Bethesda Maryland, USA).
130 Melanocytic lesions in xeroderma pigmentosum.
- 10,15 - 10,30 **P. NOEL, E. LEFTHERIOTIS, M. FAUCON, C. BAILLY, M. MAYER, J. COLON, M. GROLEAS,
M. REZVOY** (Centre Leon Berard, Lyon, France).
131 Human Malignant melanoma oncolysates «in vitro» morphological monitoring by electron
microscope.
- 10,30 - 10,45 **M. A. SECO, M. FRESNO, P. ABLANEDO** (Oviedo, Spain).
132 Apocrine sweat gland carcinoma developed on organoid naevus. Communication of one case.

FREE PAPER SESSION 7: DERMATOPATHOLOGY II

Chairman: F. Contreras (Spain).

Co Chairman: Z. Posalaky (USA).

- 11,00 - 11,15 **M. MORENO, J. A. MARTOS, S. COCA** (Hospital del Aire, Madrid, Spain).
133 Tumors of the siringuium.
- 11,15 - 11,30 **Z. POSALAKY, H. I. KATZ, D. MCGINLEY, B. CUTLER** (St. Paul Ramsey Medical Center, St. Paul, Minnesota, USA).
134 Correlation of growth and differentiation in basal cell carcinoma (BCC).
- 11,30 - 11,45 **F. CONTRERAS, M. PATRÓN, C. PÉREZ-SÁNCHEZ** (Ciudad Sanitaria "La Paz", Madrid, Spain).
135 Fibromatosis in childhood.
- 11,45 - 12,00 **M. FRESNO, P. JUNCO, T. SOLER, C. MONTE, A. HERRERO** (Ciudad Sanitaria N.S. de Covadonga, Oviedo, Spain).
136 Mixed tumor of the skin. A report of eight cases.
- 12,00 - 12,15 **V. D. VUZEVSKI, E. STOLZ, W. VAN MOURIK** (Erasmus University Medical Faculty, Rotterdam Nederland).
137 Ultrastructural study of leprosy.
- 12,15 - 12,30 **M. YENARMAN, M. DEMIRYONT** (Genel Patoloji ve Patalojik Anatomi, Univ. of Istanbul, Turkey).
138 Light and electron microscopic studies of atypical fibroxanthoma cases.
- 12,30 - 12,45 **M. A. TAGHINIA, T. GHIASSI** (Meshed, Iran).
139 Slide case presentation. Dermatopathology.

FREE PAPER SESSION 8: LIVER DISEASE I

Chairman: J. Feroldi (France).

Co Chairman: A. Viñuela (Spain).

- 09,00 - 09,15 **A. MORENO, L. RUIZ DEL ÁRBOL, S. ARECHAGA, M. T. CANDELA** (Centro Especial Ramón y Cajal, Madrid, Spain).
140 Acute liver disease in chronic carriers of HBsAg.
- 09,15 - 09,30 **I. GABOS, L. KASZA, V. FILEP, A. R. GABOS, E. SZEKELY** (Dept. Pathology, Inst. Med. Pharm., Tirgu Mures, Romania).
141 Lymphocyte-Hepatocyte interrelationship in chronic hepatitis and cirrhosis.
- 09,30 - 09,45 **A. VIÑUELA, F. FERNÁNDEZ-ROJO, J. A. VARELA, A. GONZÁLEZ-NÚÑEZ, C. NIEVES.** (Residencia Sanitaria Virgen Blanca, León, Spain).
142 Unresolved viral hepatitis with diffuse rosettoïd pattern.
- 09,45 - 10,00 **J. FEROLDI, Y. MALLET-GUY, R. BRETTE, C. TREPPO, R. ROUHIER** (Lyon, France).
143 Light and ultrastructural study of the inflammatory cells involved in viral hepatitis type B.
- 10,00 - 10,15 **T. ROTT, D. FERLUGA, M. SUHAC** (Institut Za Patologijo, Medicinska Fakulteta, Ljubljana Yugoslavia).
144 Primary liver cancer in patient with cirrhosis developing after acute viral hepatitis B. 12-Year follow up case report.
- 10,15 - 10,30 **J. SANZ ESPONERA, T. CASTIELLA MURUZÁBAL, J. LÁZARO PÉREZ** (Hospital Clínico Universitario, Zaragoza, Spain).
145 Squamous carcinoma of the liver developed in a simple non parasitic cyste.
- 10,30 - 10,45 **F. LLANES, P. ARAGONCILLO, J. FARIÑA, L. MOLINA, J. A. DE DIEGO, P. GARCÍA BARRENO, D. LUDEÑA** (Hospital Clínico de San Carlos, Madrid, Spain).
146 Experimental liver regeneration: A biochemical, endocrine and morphological study.
- 10,45 - 11,00 **J. SANZ ESPONERA, J. LÁZARO PÉREZ, M. ABASCAL AGORRETA** (Hospital Clínico Universitario, Zaragoza, Spain).
147 Experimental carcinogenesis: Hepatomas, a comparative study with human tumours.

FREE PAPER SESSION 9: LIVER DISEASE II

Chairman: L. Pollice (Italy).

Co Chairman: J. Rapola (Finland).

- 11,15 - 11,30 **J. M. CORTÉS, H. OLIVA** (Dpto. de Patología, Fundación Jiménez Díaz, Madrid, Spain).
148 Histopathology and natural history of porphyria hepatocutanea tarda hepatopathy (PHCT).
- 11,30 - 11,45 **J. RAPOLA, H. PELTOLA, L. JOKIPII** (Children's Hospital, University of Helsinki, Finland).
149 Visceral Leishmaniasis (kala azar) in a nordic country.
- 11,45 - 12,00 **F. ARNAL MONREAL, A. GARCÍA ALONSO, D. GUITIAN BARREIRO, J. FORTEZA VILA**
(Servicio de Anatomía Patológica, C. S. Juan Canalejo, La Coruña, Spain).
150 Ultrastructural study of the liver in shock.
- 12,00 - 12,15 **L. PLAZA MAS, A. FERRER DUFOL, A. MARTÍNEZ TELLO, A. CALVO ÁLVAREZ, M. T. VILLEGAS SORDO, G. TRUEBA GUILLEM** (Zaragoza, Spain).
151 Hepatic affectation in malignant lymphomas.
- 12,15 - 12,30 **F. MANZARBEITIA, J. CORTÉS, J. M. CASTRILLO, M. T. BENLLOCH, H. OLIVA** (Dpto. de Patología, Fundación Jiménez Díaz, Madrid, Spain).
152 Histopathologic ultrastructural and biochemical study of a glycogen-storage disease.
- 12,30 - 12,45 **P. JUNCO PETREMENT, C. MARTÍNEZ ALONSO, T. SOLER SÁNCHEZ, M. SECO NAVEDO, M. GONZÁLEZ GONZÁLEZ** (Ciudad Sanitaria N. S. de Covadonga, Oviedo, Spain).
153 Hepatic lesions secondary to alfa -1-antitrypsin deficiency. Report of 17 cases.
- 12,45 - 13,00 **L. POLLICE** (Bari, Italy).
154 Primary vascular tumors of the liver.

FREE PAPER SESSION 12: BONE TUMORS

Chairman: F.J. Martínez Tello (Spain).

Co Chairman: B. Sandsedt (Sweden).

- 09,00 - 09,15 **M. ARGUELLES TORAÑO, J. L. SÁNCHEZ BADÍA** (Oviedo, Spain).
169 Primary neurofibroma of bone.
- 09,15 - 09,30 **F. BERTONI, P. BACCHINI, M. CAMPANACCI** (Dpt. of Pathology, G. D'Annunzio University, Chieti, Italy, Ist. Orthopaedic Clinic, University of Bologna, Italy).
170 Intraosseous well differentiated osteosarcoma.
- 09,30 - 09,45 **M. CALVO, J. C. MARTÍNEZ, C. REDONDO** (Servicio de Anatomía Patológica, Centro Especial Ramón y Cajal, Madrid, Spain).
171 Giant cell tumour of bone. A lesion of fibrous histiocytic origen? (Report of four cases).
- 09,45 - 10,00 **L. GARBE, G. MONGES, J. SIMONY, H. PAYAN** (Aubagne, France)
172 Ultrastructural study of osteosarcomas about four cases.
- 10,00 - 10,15 **F. J. MARTÍNEZ-TELLO, J. J. NAVAS PALACIOS, M. CALVO ASENSIO, J. M. LOIZAGA IRIONDO** (Dpto. A Patológica, Ciudad Sanitaria 1.º de Octubre, Madrid, Spain).
173 Malignant fibrous histiocytoma of bone.
- 10,15 - 10,30 **V. KARAMBELA-BOUROPOULOU** (Athens, Greece).
174 Bone tumours of probable histiocytic origin.
- 10,30 - 10,45 **A. ODEGAARD, P. MARTON** (Laboratories of Surgical Pathology Ultrastructural Pathology and Immunology, Department of Pathology, The Norwegian Radium Hospital, Oslo, Norway).
175 Granulocytic sarcoma (Chloroma) preceding myelogenous leukemia.
- 10,45 - 11,00 **M. DEMIRYONT, R. ILHAN** (Department of Pathology, Istambul University, Istambul, Turkey).
176 Chordoid sarcoma.

TUESDAY SEPTEMBER 18, 1979

FREE PAPER SESSION 13: OSSEOUS AND MUSCULAR DISEASE

Chairman: J.D. Toledo (Spain)

Co Chairman: M. Forest (France).

- 11,15 - 11,30 **A. GARCÍA SÁNCHEZ, S. OLIETE, E. GÓMEZ CATALÁN, M. CALVO** (Centro Especial Ramón y Cajal, Madrid, Spain).
177 Subchondral bone cyst (intra-osseous ganglion). Anatomoradiological correlation of six cases.
- 11,30 - 11,45 **M. FOREST, J. FLAMENT, P. BOURJAT** (Paris, France).
178 Unusual osteolysis of the orbit by primary bone tumors.
- 11,45 - 12,00 **A. ORDUÑA, J. E. SERRA, M. FRESNO, I. RIESGO, A. HERRERO** (Ciudad Sanitaria N. S. de Covadonga, Oviedo, Spain).
179 Maxillary lesions. Review of 141 cases.
- 12,15 - 12,30 **M. F. ROUSSEAU-MERCK, F. JAUBERT, N. DIEBOLD, C. NEZELOF** (Laboratoire de Pathologie Pédiatrique, Hopital Necker, Paris, France).
180 Heterotransplantation of a malignant histiocytosis to nude mice.
- 12,15 - 12,30 **K. REMBERGER, S. GAY** (Pathol. Inst. Univ. München and School of Dentistry, Univ. Alabama, Birmingham, USA.).
181 Myofibroblasts and collagen types in systemic progressive sclerosis.
- 12,30 - 12,45 **C. MORALES BASTOS, M. GUTIÉRREZ MOLINA, J. FRAGA FERNÁNDEZ** (Madrid, Spain).
182 Diagnostic problems on early muscular biopsy in Werdnig Hoffmann's disease.
- 12,45 - 13,00 **L. JOZSA, S. DEMEL, A. REFFY, E. VANDOR** (National Institute of Traumatology, Budapest, Hungary).
183 The fiber type composition of hand muscles.

TUESDAY SEPTEMBER 18, 1979

14,00 - 18,15 hrs.

ROOM A

14,00 - 16,00 SLIDE SEMINAR ON NEUROPATHOLOGY AND NEUROMUSCULAR DISORDERS

Coordinator: **J. R. IGLESIAS** (Department of Pathology, Centro Especial "Ramón y Cajal", Madrid, Spain).

Rapporteurs: **J. CERVOS-NAVARRO** (Institut für Neuropathologie, Klinikum Steglitz, Berlin, Germany).

M. GUTIÉRREZ (Department of Pathology, Ciudad Sanitaria "La Paz", Madrid, Spain).

S. RAMÓN Y CAJAL (Department of Pathology, Hospital Clínico Universitario, Madrid, Spain).

16,15 - 18,15 SLIDE SEMINAR ON DERMATOPATHOLOGY

Coordinator: **F. CONTRERAS** (Department of Pathology, Ciudad Sanitaria "La Paz", Madrid, Spain).

Rapporteurs: **J. CIVATTE** (Department of Dermatology, Hopital St. Louis, Paris, France).

E. WILSON JONES (Department of Dermatopathology, St. John's Hospital, London, England).

14,00 - 17,45 **SCIENTIFIC SESSION**

PSEUDO-TUMORAL AND REACTIVE LYMPHOID DISORDERS

Chairman: H. Oliva (Madrid, Spain).

Co. Chairman: K. Henry (London, England).

H. OLIVA (Departamento de Patología, Fundación Jiménez Díaz, Madrid, Spain).

052 Pseudolymphomatous processes. Introduction.

F. RILKE (Istituto Nazionale Tumori, Milano, Italy).

053 Morphological characterization of immunoblasts.

L. J. SIMAR (Institute of Pathology, University of Liege, Belgium).

054 Morphology of the immune stimulated lymphnodes.

C. RIVAS, H. OLIVA (Departamento de Patología, Fundación Jiménez Díaz, Madrid, Spain).

055 Immunoblastic lymphadenopathy.

G. SEIFERT (Institute of Pathology, University of Hamburg, Germany).

056 Lymphoepithelial disorders of the salivary glands.

K. HENRY (Department of Histopathology, Westminster Medical School, London, England).

057 Reactive and proliferative disorders of the alimentary tract.

J. DIEBOLD (Paris, France).

058 Lymphoid pseudo-tumors.

J.A.M. VAN UNNIK (Institute of Pathology, Rijkuniversiteit, Utrecht, Holland).

59 Castleman's lymphoma.

P. MUSIANI, M. PIANTELLI, L. LAURIOLA, A. CARBONE, M. A. DINA (Department of Pathology, Catholic University, Roma, Italy).

060 Non-neoplastic nature of thymoma lymphocytes.

FREE PAPER SESSION 10: LIVER DISEASE III

Chairman: K. Lapis (Hungary).

Co Chairman: A. Matilla (Spain).

- 14,00 - 14,15 **A. LÓPEZ, J. VILCHES, A. CAMPOS, J. L. CEPERO, J. GÓMEZ** (Cat. Histología y A. Patológica, Facultad de Medicina, Cádiz, Spain).
155 X-Ray microanalysis and ultrastructural changes in hepatocytes following oral and parenteral iron overload.
- 14,15 - 14,30 **R. LLAMAS, H. GALERA, A. MATILLA, J. A. MÉNDEZ, R. GONZÁLEZ-CÁMPORA.** (Cátedra de Histología, Facultad de Medicina, Sevilla, Spain).
156 Critical analysis of the morphological criteria for the differential diagnosis of the cholestasis.
- 14,30 - 14,45 **E. MANDACHE, E. MOLDOVEANU, I. MORARU** (Victor Babes Institute, Bucharest, Romania).
157 The trapping activity of Kupffer cells.
- 14,45 - 15,00 **JO. SOARES, FC RODRIGUES, JFM NUNES, JP. CHAGAS** (Instituto de Anatomía Patológica, Fac. Medicina, Hosp. St. Maria, Lisboa, Portugal).
158 Intramitochondrial crystals of human hepatocytes: Optical diffraction analysis and testing of the unit cell model by computer tracing.
- 15,00 - 15,15 **E. IVANIVICH, G. ANTOV, M. ZLATEVA, B. KAZAKOVA, G. BOYADIEVA** (Medical Academy, Institute of Hygiene and Occupational diseases, Sofia, Bulgaria).
159 Influence of working environmental factors.
- 15,15 - 15,30 **K. LAPIS, E. UJHELYI, L. KOVÁCS, J. SCHAWARTZ** (Institute of Pathology Semmelweis Medical University, Budapest, Hungary).
160 The role of aica-phosphate in experimentally induced acute and chronic liver injuries.
- 15,30 - 15,45 **J. J. VÁZQUEZ, J. PARDO-MINDAN** (Department of Pathology, Faculty of Medicine, Pamplona, Spain).
161 Bodies similar to those of Lafora in alcoholics treated with disulfiram.
- 15,45 - 16,00 **J. VILCHES, A. LÓPEZ, A. CAMPOS, L. BARDET, J. GÓMEZ** (Cat. Histología y A. Patológica, Facultad de Medicina, Cádiz, Spain).
162 Liver sinusoidal cell in iron overload. An ultrastructural and X-ray microanalytical study.

FREE PAPER SESSION 11: MISCELLANEOUS / EXPERIMENTAL PATHOLOGY

Chairman: L. Papastamatiou (Greece).

Co Chairman: A. Martínez Ramón (Spain).

- 16,15 - 16,30 **A. CAMPOS, A. LÓPEZ, J. VILCHES, M. PALACIO, J. GÓMEZ** (Cat. Histología y A. Patológica, Facultad de Medicina, Cádiz, Spain).
163 Ultrastructural changes in experimental rat fatty liver.
- 16,30 - 16,45 **L. PAPASTAMATIOU, H. PAPASTAMATIOU, J. POULANTZAS** (Athens, Grece).
164 Pathology of the liver after hepatic outflow occlusion in the dog.
- 16,45 - 17,00 **J. O. SOARES, A. BAPTISTA, E. P. ÁLVAREZ** (Instituto de Anatomía Patológica, Fac. Medicina. Hosp. St. Maria, Lisboa, Portugal).
165 Light and ultrastructural aspects of Q fever hepatic granuloma. Experimental study in mouse.
- 17,00 - 17,15 **A. MARTÍNEZ-RAMÓN, J. RENAUI-PIQUERAS, J. CERVERA** (Inst. Investigaciones Citológicas, Valencia Spain).
166 Morphological characteristics of SKL-2 and EB-2 lines.
- 17,15 - 17,30 **L. SCHULLER, D.P.D. POPA, M. KEREKES, I. LASZLO, F. FEDOR, L. SCHULLER Jr., M. SCHULLER, I. O. STEF** (Tirgu-Mures, Romania).
167 Heterotransplantation of tumoral cell culture (DETROIT-6/VA/, KB cell line) into the eye.
- 17,30 - 17,45 **J. SAIKKONEN** (II Department of Pathology, University of Helsinki, Helsinki, Finland).
168 Acceleration of heat production in rat tissues exposed to high environmental temperatures.
- 17,45 - 18,00 **T.G. MIRALLES, S. CAPEROS, A. RIBAS, V.S. FOLGUERAS** (Department of pathology H.G.A., Oviedo, Spain).
168 B Quelamycin and iron deposits in the liver.

FREE PAPER SESSION 14: FEMALE GENITAL DISEASE I

Chairman: L. Capote de Armas (Spain).

Co Chairman: J. M. Vera (Spain).

- 14,00 - 14,15 **J. J. VILANOVA, H. SHINGLETON, J. M. RIVERA** (Lejona, Vizcaya, Spain).
184 Postmenopausal neoplasia of the cervix uteri: Is it estrogen dependent ?
- 14,15 - 14,30 **C. MOEBIUS, J. CEILING** (Department of Pathology, Pathologisches Institut, Schwerin, Germ. Dem. Republic).
185 Ten Years Screening for cervical cancer: Influence on incidence and mortality.
- 14,30 - 14,45 **M. O. KORHONEN, F. STENBAK** (Departments I and II of Obstetrics and Gynecology, University Central Hospital of Helsinki, Department of Pathology, University of Kuopio, Finland).
186 Metastatic adenocarcinomas in the uterine cervix.
- 14,45 - 15,00 **J. M. MARTÍNEZ-PEÑUELA, A. DOMÍNGUEZ, M. L. GÓMEZ, A. PURAS, R. CERES** (Pamplona, Spain).
187 Apoptosis in endometrial epithelium.
- 15,00 - 15,15 **D. STOJANOVIC** (Nis, Yugoslavia).
188 Histochemical study of redox ferments of glandular hyperplasias of the human endometrium.
- 15,15 - 15,30 **H. PAPASTAMATIOU, AL. KLISSARISTOS** (Athens, Greece).
189 The incidence of adenomatous hyperplasia among young women.
- 15,30 - 15,45 **A. KLISSARISTOS, H. PAPASTAMETIOY** (Athens, Greece).
190 The incidence of unsuspected adenomyosis-endometriosis in gynaecological operations.

FREE PAPERS SESSION 15: FEMALE GENITAL DISEASE II

Chairman: C. A. Rubio (Sweden).

Co Chairman: M.L. Carneiro de Moura (Portugal).

- 16,15 - 16,30 **C. A. RUBIO** (Department of Pathology, Karolinska Sjukhuset, Stockholm, Sweden).
191 Cell population kinetics of the cervical epithelium during carcinogenesis.
- 16,30 - 16,45 **M. L. CARNEIRO DE MOURA, M. BOTELHO** (Instituto Anatomia Patologica, Faculdade de Medicina, Lisboa, Portugal).
192 Intrauterine contraception: a combined histologic and cytologic study.
- 16,45 - 17,00 **I. SANZ GONZÁLEZ DE SUSO, L. CAPOTE ARMAS, C. MARCOS MUÑOZ, J. DE DANIEL GÓMEZ** (Madrid, Spain).
193 Cytologic and histologic correlation in atypical hyperplasic lesions of uterine cervix.
- 17,00 - 17,15 **K. STROMBERG, R. HUOT, K. B. SPEEG, JR, J. C. AZIZKHAN** (National Cancer Institute, Bethesda, Maryland, USA).
194 An in vitro comparison of the regulation of expression of chorionic gonadotropin and alkaline phosphatase in normal and malignant trophoblast.
- 17,15 - 17,30 **J. M. POLAK, A. E. BISHOP** (Royal Postgraduate Medical School, London, England).
195 The vip innervation of the human female genital tract.
- 17,30 - 17,45 **J. M. GARCÍA GARCÍA, M. C. MARTÍNEZ ALONSO, J. E. SERRA TRESPALLÉ** (Oviedo, Spain).
196 A review of 780 frozen sections.

WEDNESDAY SEPTEMBER 19, 1979
09,00 - 13,00 PLENARY SESSION

09,00 - 13,00 hrs.

ENDOSCOPIC PATHOLOGY OF THE GASTRO INTESTINAL TRACT

Chairman: J. M. Rivera (Bilbao, Vizcaya, Spain)

Co Chairman: P. Gedigk (Bonn, Germany).

J. M. RIVERA (Bilbao, Vizcaya, Spain).

014 Endoscopic gastrointestinal pathology. Introduction and general remarks.

V. IDIONDO-ARTECHE (Algorta, Vizcaya, Spain).

015 Technical and diagnostic problems on esophageal and gastric endoscopy.

C. BENASCO (Ciudad Sanitaria "Príncipes de España", Hospitalet, Barcelona, Spain).

016 Esophagic pathology. Peptic esophagitis.

P. GEDIGK (Institute of Pathology, University of Bonn, (Bonn, Germany).

017 Precancerosis of the gastric mucosa.

F. J. BILBAO-ERCORECA (Bilbao, Vizcaya, Spain).

018 Endoscopic biopsy: histological grading of atypical lesions.

C. BENASCO, P. BILBAO (Ciudad Sanitaria "Príncipes de España", Hospitalet, Barcelona and Ciudad Sanitaria "Enrique de Sotomayor", Bilbao, Vizcaya, Spain).

019 Superficial gastric carcinoma.

F. J. BILBAO-ERCORECA (Bilbao, Vizcaya, Spain).

020 Morpho-epidemiological correlation on gastric cancer.

C. BENASCO (Ciudad Sanitaria "Príncipes de España", Hospitalet, Barcelona, Spain).

021 Post-gastrectomy anastomotic lesions.

J. M. POLAK, S. R. BLOOM (Royal Postgraduate Medical School, London, England).

022 Gut hormone pattern distribution in health and disease. A study using endoscopic biopsies.

J. MONES (Service of Digestive Pathology, Hospital de la Santa Cruz y San Pablo, Facultad de Medicina, Universidad Autónoma, Barcelona, Spain).

023 Endoscopic exfoliative cytology in gastroenterology.

WEDNESDAY SEPTEMBER 19, 1979

14,00 - 18,15 hrs.

ROOM A

14,00 - 16,00 SLIDE SEMINAR ON NON-TUMORAL DISORDERS OF THE LIVER

Coordinator: **E. CAÑADAS** (Department of Pathology, Ciudad Sanitaria "Principes de España", Hospitalet de Llobregat, Barcelona, Spain).

Rapporteurs: **H. W. ALTMANN** (Institute of Pathology, University of Wurzburg, Germany).

V. DESMET (Department of Pathology, School of Medicine, Catholic University, Lovaina, Belgium).

16,15 - 18,15 SHORT COURSE ON SOFT TISSUE TUMORS

Coordinator and Rapporteur: **F. M. ENZINGER** (Department of Soft Tissue Pathology, A.F.I.P., Washington, USA)

WEDNESDAY SEPTEMBER 19, 1979

14,00 - 16,00 hrs.

ROOM B

14,00 - 16,00 SHORT COURSE ON METABOLIC DISEASE OF BONE TISSUE

Chairman: **C. WOODS** (Department of Pathology, The Nuffield Orthopaedic Centre, Oxford, England).

Speakers: **M. EARNSHAW** (Oxford, England).

R. SMITH (Oxford, England).

C. WOODS (Oxford, England).

FREE PAPER SESSION 16: GASTROINTESTINAL DISEASE I

Chairman: I. Moraru (Romania).

Co Chairman: V. Tamarit (Spain).

- 14,00 - 14,15 **F. J. BILBAO, V. IDIONDO, A. BILBAO, M. SAN VICENTE** (Bilbao, Vizcaya, Spain).
197 Gastric and esophageal pathology diagnosed by endoscopic biopsy. A clinical and epidemiological analysis.
- 14,15 - 14,30 **M. RAYON, A. FROUFE, J. TERRÁDEZ, E. MAYAYO, V. PERTEJO, T. SALA, V. TAMARIT** (Dto. A. Patológica, Ciudad Sanitaria "La FE", Valencia, Spain).
198 Early gastric cancer (EGC). Report of 30 cases.
- 14,30 - 14,45 **N. MUÑOZ, M. CRESPI, A. GRASSI, B. ARAMESH** (International Agency for Research on Cancer, Lyon, France; Regina Elena Institute, Rome, Italy and Taj Pahlavi Cancer Institute, Teheran, Iran).
199 Oesophagoscopical survey in Northern Iran.
- 14,45 - 15,00 **P. GARÍN CHESA, J. M. POLAK, C. M. TIMSON, A. G. E. PEARSE** (Royal Postgraduate Medical School, London, England).
200 Histochemical and ultrastructural studies on 9 cases of multiple gastric carcinoids.
- 15,00 - 15,15 **V. KATIC, D. DOJČINOV, C. KUTLESIC** (Institute of Pathology Medical Faculty, University of Niš, Yugoslavia).
201 Apud cells in stomachs of patients suffering from antral gastritis and pernicious anemia.
- 15,15 - 15,30 **S. PALACIOS, F. VAL, J. CASTRO** (Dto. A. Patológica, C.M.N. Valdecilla, Santander, Spain).
202 Toxoplasmosis mimicking malignant histiocytosis and presenting as a gastric tumor.
- 15,30 - 15,45 **I. MORARU, FL. HALALAU, D. LAKY** (Victor Babes Institute, Bucharest, Romania).
203 Gastrointestinal inflammatory fibroid polyps. Immunomorphological considerations.
- 15,45 - 16,00 **C. F. MONTE** (Oviedo, Spain).
204 Inflammatory fibroid polyp of the terminal ileum. A report of two cases.

FREE PAPER SESSION 17: GASTROINTESTINAL PATHOLOGY II

Chairman: J. Zangger (Austria)

Co Chairman: F. Val-Bernal (Spain).

- 16,15 - 16,30 **F. VAL-BERNAL, M. F. GARIJO, H. OLIVA** (Dpto. A. Patológica, C.M.N. Valdecilla, Santander, Spain).
205 Cystic acinic cell tumor of the parotid gland.
- 16,30 - 16,45 **J. MA, W.G.R.M. DE BOER, H.A. WARD, R.N. NAIRN** (Victoria, Australia).
206 Mucin of the small intestine in mucinous carcinomas of the colon.
- 16,45 - 17,00 **J. ZANGGER, M. TAUFER** (Institute of Pathology, University Graz, Austria).
207 Adenoma of the rectum with cell atypia and carcinoma in adenoma.
- 17,00 - 17,15 **S. FIALA, E. TROUT, B. PRAGANI, E.S. FIALA** (Cell Physiology Laboratory, Veterans Medical Center, Martinsburg West Virginia and Dana Naylor Institute, Valhalla, N.Y., USA).
208 Elevated activity of γ -glutamyl transferase in cancer of colon.
- 17,15 - 17,30 **C. MONTERO, J. M. LOIZAGA, D. I. SEGURA** (Dept. Anatomia Patológica, Ciudad Sanitaria de la Seguridad Social, Sevilla, Spain).
209 Retrospective study of mucosubstances in adenocarcinomas of the GI tract.
- 17,30 - 17,45 **S. SIEW** (Michigan State University, East Lansing, Michigan, USA).
210 Scanning electron microscopy of the gastro-intestinal tract.
- 17,45 - 18,00 **H. HELIN, M. MERO, M. HELLE, H. MARKKULA** (Tampere, Finland).
211 Ultrastructural changes in human acute pancreatitis.
- 18,00 - 18,15 **S. M. CHIARELLI, P. DALLA PALMA, F. SANDEI** (Istituto di Anatomia Patologica, Universita, Padova, Italy).
212 Intestinal pathology at the site of ureterosigmoidostomy.

FREE PAPER SESSION 18: ENDOCRINOLOGY

Chairman: J. Polak (U.K.).

Co Chairman: C. Calmettes (France).

- 14,00 - 14,15 **A. ALONSO, V. CUSI, J. VILA, C. PAVÍA** (Barcelona, Spain).
213 Chronic lymphocytic thyroiditis in childhood. Report of five cases.
- 14,15 - 14,30 **C. CALMETTES, M. C. FONDANECHÉ, P. BURTIN** (Paris, France).
214 Detection of calcitonin, CEA and cross reacting antigens in medullary carcinoma of the thyroid.
- 14,30 - 14,45 **H. GALERA, J. AMERIGO, R. GONZÁLEZ-CAMPORA, A. MATILLA, J. FERNÁNDEZ-SANZ**
(Catd. de Histología, Facultad de Medicina, Sevilla, Spain).
215 Morphometric and functional study of experimental thyroid regeneration.
- 14,45 - 15,00 **P. KETELBANT-BALASSE, F. DELANGE** (Brussels, Belgium).
216 Morphological and functional study of the thyroid gland in the newborn.
- 15,00 - 15,15 **R. TRINCAO, M. I. MARTINS, R. ALMEIDA** (Facultade de Medicina Coimbra, Portugal).
217 Thyroid medullary carcinoma.
- 15,15 - 15,30 **R. GOLOUH, M. US-KRASOVEC, M. AUERSPERG, J. LAMOVEC** (Institute of Oncology, Ljubljana, Yugoslavia).
218 Fine-needle aspiration biopsy (AB) and frozen section (FS) versus final histological diagnosis in malignant tumors of thyroid gland.
- 15,30 - 15,45 **M. US-KRASOVEC, R. GOLOUH, M. AUERSPERG, J. LAMOVEC** (The Institute Of Oncology, Ljubljana, Yugoslavia).
219 Fine-needle aspiration biopsy (AB) in thyroid gland lesions.
- 15,45 - 16,00 **J. BURGOS, G. GARRIGA, F. ORTEGA, P. ELORRIAGA, J. M. RIVERA** (Bilbao, Vizcaya, Spain).
220 Pure oxyphilic adenomas and hyperparathyroidism: Ultrastructural observations on three cases.

FREE PAPER SESSION 19: BREAST DISEASE

Chairman: C. W. Elston (England).

Co Chairman: R. Gareau (Canada)

- 16,15 - 16,30 **C. W. ELSTON, J. JOHNSON, H. BISHOP, R. W. BLAMEY, K. GRIFFITHS** (Department of Pathology, City Hospital Hucknall Road, Nottingham, England).
221 The relationship of oestrogen receptor status and histological tumor differentiation with prognosis in human breast carcinoma.
- 16,30 - 16,45 **N. J. AGNANTIS, P. P. ROSEN** (Athens, Greece).
222 Mammary carcinoma with osteoclast-like giant cells. A study of eight cases with follow-up.
- 16,45 - 17,00 **J. GARRIGA, J. BURGOS, J. VILANOVA, A. BILBAO, J. M. RIVERA** (Bilbao, Vizcaya, Spain).
223 Apocrine carcinoma of breast. A presentation of three nipple related cases and review of the literature.
- 17,00 - 17,15 **A. IPLIKCI, I. PETORAK** (Department of Pathology, Istanbul University, Turkey).
224 Comparative ultrastructure of fibroadenoma and pure infiltrating ductal carcinoma of the breast.
- 17,15 - 17,30 **J. M. RIVERA, J. J. VILANOVA, M. C. AROCENA** (Bilbao, Vizcaya, Spain).
225 Fibrous disease of Breast: An often ignored and ill-defined entity.
- 17,30 - 17,45 **I. PERORAK, A. IPLIKCI** (Departments of Histology-Embryology, Istanbul, Turkey).
226 The ultrastructure of fibrocystic disease and fibroadenomas of the breast.
- 17,45 - 18,00 **P. MAVEC, I. F. LENART** (Institute of Oncology, Ljubljana, Yugoslavia).
227 Lymphoid infiltration in human breast tumors.
- 18,00 - 18,15 **E. SALINERO, E. ÁLVAREZ-FERNÁNDEZ** (Anatomía Patológica, Ciudad Sanitaria Prov. Fco. Franco, Madrid, Spain).
228 Ultrastructural study of mammary gland haemangiosarcomas.
- 18,15 - 18,30 **L. GHOSH, B. C. GHOSH** (Department of Pathology, Abraham Lincoln School of Medicine, University of Chicago, Illinois, USA.).
229. Localization of growth hormone in mammary carcinoma cells by horseradish and anti-horseradish peroxidase complex.

THURSDAY SEPTEMBER 20, 1979

09,00 - 13,00 hrs.

ROOM A

09,00 - 13,00 PLENNARY SESSION

GERM CELL TUMORS

Chairman: R. Varela-Núñez (Santiago de Compostela, Spain).
Co Chairman: F.F. Nogales Jr. (Sevilla, Spain)

J. A. GAILLARD (Paris, France).

024 Comparative histogenesis of teratoid germ-cell tumours.

I. DAMJANOV (Hahnemann Medical College, Philadelphia, USA).

025 Experimental Germ-cell tumors.

A. MUNRO-NEVILLE (Ludwigs Institute for Cancer Research, Sutton, England).

026 Germ cell tumor markers.

A. TALERMAN (Chicago, USA).

027 Seminoma and disgerminoma.

F. F. NOGALES Jr. (Hospital Clinico Universitario, Sevilla, Spain).

028 The yolk sac tumour group.

N. J. BROWN (Department of Pathology, Southmead Hospital, Bristol, England).

029 The pathology of immature teratomas.

R. VARELA-NÚÑEZ (Hospital Clinico Universitario, Santiago de Compostela, Spain).

030 Extragonadal germ cell tumors.

R. C. B. PUGH (St. Peter Hospital, London, England).

031 Testicular teratoma. Clinico-pathological features.

09,00 - 13,00 SYMPHOSIUM

TRAINING PROGRAMMES IN PATHOLOGY

Chairman: A. Anaya (Madrid, Spain).

Co Chairman: P. Dustin (Bruxelles, Belgium).

Rapporteur: H. U. Zollinger (Basel, Switzerland).

A. ANAYA (Clínica Puerta de Hierro, Facultad de Medicina, Universidad Autónoma, Madrid, Spain).

077 A proposition of basic ideas for the teaching of pathology. Introduction to the round table on this subject.

H. U. ZOLLINGER (Institute of Pathology, Basel, Switzerland).

078 Overview of pregraduate teaching in pathology.

P. DUSTIN (Department of Pathology, Université Libre de Bruxelles, Belgium)

079 Some current problems in the teaching of graduate pathology.

H. JELLINEK (2nd Department of Pathology, Semmelweis Medical University, Budapest, Hungary).

080 Basic requirements of pathology for a physician.

G. J. V. SWAEN (St Annadal, Maastricht, The Netherlands).

081 Integrated teaching of pathology and other disciplines?

E. A. SAXEN (Helsinki, Finland).

082 Pathology, clinical or preclinical subject?

P. DE SAINT-MAUR (Paris, France).

083 Is it possible to have an international program of pre-graduate pathology?

H. U. ZOLLINGER (Institute of Pathology, Basel, Switzerland).

084 Overview of postgraduate education in pathology.

R. E. COTTON (City Hospital, Nottingham, England)

085 Recruitment to pathology: past, present and future problems.

E. GRUNDMANN (Institute of Pathology, University of Münster, Germany).

086 Pre- and postgraduate training programs in the F.R.G.

E. A. SAXEN (Helsinki, Finland).

087 Continued education in pathology.

H. JELLINEK (2nd Department of Pathology, Semmelweis Medical University, Budapest, Hungary).

088 Contents and formal problems of teaching pathology.

G. J. V. SWAEN (St. Annadal, Maastricht, The Netherlands).

089 Pathology in the continued education of other disciplines.

P. DE SAINT-MAUR (Paris, France).

090 A european pathologist?

FREE PAPER SESSION 20: KIDNEY DISEASE I

Chairman: D. Ferluga (Yugoslavia).

Co Chairman: P.J. Brundelet (Norway).

- 09,00 - 09,15 **N. SARACIBAR, M. CARRERA** (Barcelona, Spain).
230 Endo-extracapillary glomerulonephritis: Optical, immunofluorescent and ultrastructural study of 20 cases.
- 09,15 - 09,30 **I. RIESGO, J. RODRÍGUEZ-PANDIELLA, P. ABLANEDO** (Oviedo, Spain).
231 Glomerulonephritis caused by antibodies anti-glomerular basement membrane (Presentation of 4 cases).
- 09,30 - 09,45 **F. J. PARDO-MINDAN, M. SOBRINI, A. SÁNCHEZ IBARROLA** (Pamplona, Spain).
232 Histological features of the nephrotic syndrome associated with echinococcosis.
- 09,45 - 10,00 **D. FERLUGA, A. HVALA, A. VIZJAK, B. ROZMAN, P. JEZERSEK, E. DARIAN-PIRC, S. LUZAR, J. DRINOVEC** (Institute of Pathology, Ljubljana, Yugoslavia).
233 The value of electron microscopy /EM/ and immunofluorescence /IF/ in study of lupus glomerulonephritis /L-GN/.
- 10,00 - 10,15 **L. FOGUE, F. MAMPASO, J. ECIJA, M. SÁNCHEZ, N. GALLEGO, A. GONZALO, C. GANCEDO** (Centro Especial Ramón y Cajal, Madrid, Spain).
234 Rothmund and Thompson syndrome associated with IgM mesangial nephropathy occurring in three siblings.
- 10,15 - 10,30 **F. MAMPASO, C. BELLAS, L. FOGUE, A. GONZALO, J. TERUEL** (Madrid, Spain).
235 IgM nephropathy: Primary mesangial proliferative glomerulonephritis as defined by immunohistochemical findings.
- 10,30 - 10,45 **C. PADROL, A. ZAMARRÓN, A. OLIVER, I. MOGA, M. CARRERA** (Barcelona, Spain).
236 Renal damage in systematic lupus eritematosus without urinary abnormalities.
- 10,45 - 11,00 **J. FERNÁNDEZ SANZ, H. GALERA, J. R. ARMAS, A. MATILLA** (Cat. Histología, Facultad de Medicina, Sevilla, Spain).
237 Morphological study of the nephropathy associated with viral hepatitis.

FREE PAPER SESSION 21: KIDNEY DISEASE II

Chairman: P. Hermanek (Germany).

Co Chairman: J. Stejskal (Czechoslovakia).

- 11,15 - 11,30 **J. B. FOIDART, J. M. FOIDART, C. DECHENNE, C. DUBOIS, P. MAHIEU** (State University of Liege, Belgium).
238 Immunofluorescent studies on glomerular epithelial and mesangial cells in culture.
- 11,30 - 11,45 **J. STEJSKAL, V. KREN, L. PAVKOVA** (Prague, Czechoslovakia).
239 Giant cell interstitial nephritis in the transplanted rat kidney.
- 11,45 - 12,00 **C. DUBOIS, J. FOIDART, M. HAUTIER, C. DECHENNE, P. MAHIEU** (State University of Liege, Belgium).
240 Tissue culture of glomeruli isolated from rat kidneys with proliferative glomerulonephritis (GN).
- 12,00 - 12,15 **M. L. DE LA PEÑA, J. BLANCO, C. MARTÍN, A. ACEVEDO, A. MARTÍNEZ** (Madrid, Spain).
241 Renal lesions in hypothyroid rats. A light and ultrastructural study.
- 12,15 - 12,30 **C. DECHENNE, C. DUBOIS, J. FOIDART, M. HAUTIER, P. MAHIEU** (State University of Liege, Belgium).
242 Ultrastructural studies on infiltrating cells in an experimental proliferative glomerulonephritis.
- 12,30 - 12,45 **F. J. MATHIEU, J. B. FOIDART, C. H. DUBOIS, C. DECHENNE, P. R. MAHIEU** (Departments of Medicine and Pediatrics, State University of Liege, Belgium).
243 Glomerular lesions in experimental pyelonephritis.
- 12,45 - 13,00 **P. HERMANEK, A. SIGEL, S. CHLEPAS** (Erlangen, Germany).
244 Grading and staging in renal cell cancer.

THURSDAY SEPTEMBER 20, 1979

09,00 - 10,45 hrs.

FREE PAPER SESSION 24: LUNG TUMORS

Chairman: G. Diaconita (Romania).

Co Chairman: J. Pérez-Villanueva (Spain).

- 09,00 - 09,15 **T. G. MIRALLES, C. LOBO, C. URRUTIA, A. ASTUDILLO** (Department of Pathology H.G.A., Oviedo, Spain).
261 Diagnosis of pathology of the lung by needle aspiration Bx., by trocar or chiba.
- 09,15 - 09,30 **J. C. PIMENTEL, A. P. MENEZES** (Institute of Pathology, Faculty of Medicine, University of Lishoa, Portugal).
262 Granulomatous disease with alveolar cell carcinoma due to the inhalation of powdered DDT.
- 09,30 - 09,45 **H. PAPASTAMATIOU, R. TRIGIDOU, D. IKKOS** (Athens, Greece).
263 Endocrine changes in lung cancer. A C T H serum levels in patients with oat cell carcinoma.
- 09,45 - 10,00 **O. FERRER-ROCA** (University of Barcelona, Spain).
264 Intravascular and sclerosing bronchioalveolar tumor. Case report with ultrastructural study.
- 10,00 - 10,15 **G. DIACONITA, A. ESKENASY, P. NICOLESCU** (Department of Pathology, Institute of Virology, Bucharest, Romania).
265 Analytical anatomo-histological study of 4500 cases of pulmonary carcinomas.
- 10,15 - 10,30 **E. ÁLVAREZ-FERNÁNDEZ** (Ciudad Sanitaria Prov. Fco. Franco, Madrid, Spain).
266 Intracytoplasmic fibrillary inclusions in bronquial carcinoid.
- 10,30 - 10,45 **M. ARGUELLES TORANO, I. BLANCO BLANCO** (Oviedo, Spain).
267 Inflammatory bronquial polyps associated with asthma.

FREE PAPER SESSION 25: LUNG DISEASE

Chairman: L. Díaz-Flores (Spain).

Co Chairman: J. Roland (France).

- 11,00 - 11,15 **A. LINHARTOVÁ** (Plzeň, Czechoslovakia).
268 The distance and delineation of alveolar attachments to the walls of nonrespiratory bronchioles in normal and emphysematous lungs.
- 11,15 - 11,30 **F. LÓPEZ-BAREA, C. GAMALLO, J. M. VIGUER, C. PERERA, J. LÓPEZ-SENDON** (Madrid, Spain).
269 Morphologic pictures of pulmonary hypertension.
- 11,30 - 11,45 **M. BEDIVAN** (Clinic of Gynecology and Obstetrics, Bucharest, Romania).
270 Pulmonary morphologic alterations in post abortum endotoxic shock.
- 11,45 - 12,00 **I. SOLE RAMÓN, R. BERNAT LANDONI, I. OJANGUREN SABAN, E. SPAGNOLO DE LA TORRE** (Barcelona, Spain).
271 The green pulmonary edema.
- 12,00 - 12,15 **D. St. SCHMIDT, R. RIEDL-SEIFERT** (Kassel, Germany).
277 Morphology of asthma bronchiale and therapeutic consequences.
- 12,15 - 12,30 **C. RODRÍGUEZ CASQUERO, F. J. SANCHO POCH, S. BENITO VALES, A. ARTIGAS RAVENTÓS** (Barcelona, Spain).
273 Lung pathology in intensive care unit.
- 12,30 - 12,45 **J. ROLAND, S. VALADE, S. MAYAUD, F. CHATELET, J. MERLIER, S. BOUCHOUCHA, J. MARSAC** (Hopital Tenon, Paris, France).
247 Immunofluorescence (I.F.) studies in acute extensive pneumonitis.
- 12,45 - 13,00 **J. M. COROMINAS TORRES** (Barcelona, Spain).
275 Pulmonary thromboembolism study (PTE) in autopsy material.

THURSDAY SEPTEMBER 20, 1979

14,00 - 18,15 hrs.

14,00 - 16,00 SLIDE SEMINAR ON HEMATOPATHOLOGY

Coordinator: **H. A. AZAR** (Laboratory Service, Veterans Administration Hospital and Department of Pathology, University of South Florida, College of Medicine, Tampa, Florida, USA).

Rapporteurs: **R. BURKHARDT** (Abteilung für Knochenmarksdiagnostik an der Medizinischen Klinik Innenstadt der Universität München, Germany).

A. GEORGII (Pathologisches Institut der Medizinischen Hochschule, Hannover, Germany).

16,15 - 18,15 SLIDE SEMINAR ON BONE TUMORS

Coordinator: **J. M. LOIZAGA** (Department of Pathology, Ciudad Sanitaria "Virgen del Rocío", Sevilla, Spain).

Rapporteurs: **M. CALVO** (Department of Pathology, Centro Especial "Ramón y Cajal", Madrid, Spain).

F. J. MARTÍNEZ-TELLO (Department of Pathology Ciudad Sanitaria "1.º de Octubre", Madrid, Spain).

C. WOODS (Department of Pathology, The Nuffield Orthopaedic Centre, Oxford, England).

18,30 hrs. GENERAL ASSEMBLY OF THE EUROPEAN SOCIETY OF PATHOLOGY

Agenda

1. Opening remarks by the President
2. Report of the Secretary.
3. Report of the Treasurer.
4. Election of the new Executive Committee.
5. Election of a new (Consultative) Council.

14,00 - 17,45 **SCIENTIFIC SESSION**

CHEMICAL NEUROCARCINOGENESIS

Chairman: A. Bullon-Ramírez (Madrid, Spain).

Co Chairman: A. Cardesa (Valladolid, Spain).

A. BULLÓN-RAMÍREZ (Departamento de Anatomía Patológica, Hospital Clínico Universitario, Madrid, Spain).

061 Introduction to chemical neurocarcinogenesis.

H. BARTSCH, C. MALAVEILLE, G. F. KOLAR (International Agency for Research on Cancer, Lyon, France and Deutsches Krebsforschungszentrum, Heidelberg, Germany).

062 Some aspects of metabolic activation of neurocarcinogens in relation to their organ specificity.

U. MOHR, U. GREEN, J. ALTHOFF (Abteilung für Exp. Pathologie, Medizinische Hochschule, Hannover, Germany),

063 Transplacental and mother's milk carcinogenesis in the induction of neurogenic tumours.

M. RUSTIA, R. SHUMAN (Eppley Institute for Cancer Res., Omaha, Nebraska, USA).

064 Reactions of neurocarcinogen precursors and their possible inhibition.

H. D. MENNEL (Neurologische Klinik, Köln, Germany).

065 Morphology of experimental central nervous system tumors with special reference to comparative aspect in the human.

A. CARDESA, F. LLANES, V. FURIÓ (Departamento de Anatomía Patológica, Hospital Clínico Universitario, Valladolid, Spain).

066 Morphology of experimental tumours of the peripheral nervous system and its comparison to man.

J. MERCHAN, J. J. MATEOS, T. ÁLVAREZ-GAGO (Departamento de Anatomía Patológica, Hospital Clínico Universitario, Madrid, Spain).

067 Electron microscopy of experimental tumours of the nervous system.

FREE PAPER SESSION 22: GENITOURINARY DISEASE

Chairman: P. Dalla Palma (Italy).

Co Chairman: M. S. Al Adnani (Iraq).

- 14,00 - 14,15 **B. CORTES, M. V. JORDÁ, L. V. TAMARIT** (Valencia, Spain).
245 The pathology of cancer of the prostate. Analytical review of cases at "La Fe" Medical Center (1969-1978).
- 14,15 - 14,30 **J. J. VILANOVA, J. BURGOS, J. M. RIVERA** (Bilbao, Vizcaya, Spain).
246 Malakoplakia and "xanthogranulomatous" inflammation of the urinary tract and male genital system: A similar entity?
- 14,30 - 14,45 **J. McLURE, S. STEVENS** (Institute of Medical and Veterinary Science, Adelaide, Australia).
247 The Histochemical characteristics of the Michaelis Gutmann body.
- 14,45 - 15,00 **H. H. DAHM, H. RUBBEN, W. VAN UELFT** (Abteilung Anatomie der RWTH Aachen, Germany).
248 Transitional cell carcinoma of the urinary bladder: a retrospective study in the area of Aachen (FRG).
- 15,00 - 15,15 **P. DALLA PALMA, M. PIAZZA, S. CHIARELLI** (Istituto di Anatomia Patologica, Università, Padova, Italy).
249 Adenocarcinoma of the bladder.
- 15,15 - 15,30 **M. S. AL ADNANI** (Department of Pathology, College of Medicine, Basrah, Iraq).
250 Extra urinary schistosomiasis in southern Iraq.
- 15,30 - 15,45 **J. J. SIRVENT CALVERA, M. PLADELLORENS ROCA, A. PUJOL LARRE, R. BERNAT LANDONI** (Barcelona, Spain).
251 Histometric assessment and ultrastructure of testis with idiopathic varicocele.
- 15,45 - 16,00 **L. SANTAMARÍA, M. NISTAL** (Madrid, Spain).
252 Morphometric study of testicular biopsies in Del Castillo syndrome. (Sertoli cell only syndrome).

FREE PAPER SESSION 23: ENDOCRINOLOGY II

Chairman: G. Ortuño (Spain).

Co Chairman: N. B. Friedman (USA).

- 16,15 - 16,30 **J. M. POLAK, J. WHARTON, S. R. BLOOM, J. A. WILL, A. G. E. PEARSE** (Royal Postgraduate Medical School, London, England).
253 Peptidergic (Substance P) innervation of the lung.
- 16,30 - 16,45 **V. KATIĆ, D. DOJĆINOV, R. ILIĆ** (Institute of Pathology, Medical Faculty, University of Niš, Yugoslavia).
254 New Pancreatic tumor pipoma.
- 16,45 - 17,00 **J. FANEGO, J. VARELA, M. TORO, E. PÉREZ-BECERRA** (Department of Pathology, Medical Faculty, Santiago de Compostela, Spain).
255 Non-functioning islet cell tumors.
- 17,00 - 17,15 **J. M. POLAK, J. WHARTON, M. G. BRYANT, S. R. BLOOM** (Royal Postgraduate Medical School, London, England).
256 Vip innervation of salivary glands.
- 17,15 - 17,30 **J. M. VERLEY, K. H. HOLLMANN** (Hopital Marie-Lannelongue, Le Plessis Robinson, France).
257 Neuro-endocrine (carcinoid) tumors of the thymus. An electron microscope study of three cases.
- 17,30 - 17,45 **N. B. FRIEDMAN** (Cedars-Sinai Medical Center, Los Angeles, California, USA).
258 Carcinoid enteropathy.
- 17,45 - 18,00 **V. E. GOULD, C. V. REYES, W. JAO, G. CHEFJEC** (Chicago, Illinois, USA).
259 Neuroendocrine carcinomas of the esophagus.
- 18,00 - 18,15 **J. M. POLAK, A. BISHOP, M. G. BRYANT, S. R. BLOOM** (Royal Postgraduate Medical School, London, England).
260 Peptidergic innervation of the human and rat pancreas.

FREE PAPER SESSION 26: GERM CELL TUMORS

Chairman: R. E. Scully (USA).

Co Chairman: J. Szamborski (Poland).

- 14,00 - 14,15 **M. TORO, J. VARELA, R. VARELA** (Department of Pathology, Medical Faculty, Santiago de Compostela, La Coruña, Spain).
276 Endodermal sinus tumor with renal affectation.
- 14,15 - 14,30 **D. TAVCAR, S. J. ROBBOY** (Ljubljana, Yugoslavia, and Boston, U.S.A.).
277 Endodermal sinus tumor of the central nervous system.
- 14,30 - 14,45 **M. USED AZNAR, I. VALERO, C. NAVARRO, J. PAC, C. CARO, J. VERA, C. BALLESTIN** (Zaragoza, Spain).
278 Testicular germ tumors: Review of 34 cases.
- 14,45 - 15,00 **M. SCHOLZ, I. VARADI** (Budapest, Hungary).
279 The occurrence of germ cell tumours in our practice.
- 15,00 - 15,15 **J. SZAMBORSKI** (Inst. Obst. Gynec, Warszawa, Poland).
280 Germ cell tumours in the ovarian tumours registry of the Polish Society of Pathologists).
- 15,15 - 15,30 **R. H. YOUNG, W. R. WELCH, R. E. SCULLY, G. R. DICKERSIN** (Department of Pathology, Massachusetts General Hospital, Boston, Massachusetts, USA.).
281 Ovarian sex cord tumor with annular tubules. Review of 49 cases including 15 with Peutz-Jeghers syndrome, four of whom had adenoma malignum of the cervix.
- 15,30 - 15,45 **P. J. KLEMI, T.J. NEVALAINEN, T. EKFOR, M. GRÖNROOS** (Departments of Pathology and Obstetrics and Gynecology, University of Turku, Finland).
282 Value of electron microscopy in the diagnosis of ovarian epithelial tumours.
- 15,45 - 16,00 **J. PRAT** (Department of Pathology, Massachusetts General Hospital, Harvard Medical School, Boston, Massachusetts, USA).
283 Primary ovarian sarcomas and related tumors: A clinico-pathologic analysis of 37 cases.

FREE PAPER SESSION 27: FEMALE GENITAL DISEASE III

Chairman: F. Stenback (Finland).

Co Chairman: G. García Julián (Spain).

- 16,15 - 16,30 **M. A. CHRESTIAN, D. VINCENTI, R. LIEUTAUD, D. VAGUE** (Institut Paoli Calmettes, Marseille, France).
284 Proliferative Brenner's tumor: one case report.
- 16,30 - 16,45 **M. CLAVER, J. I. RODRÍGUEZ, J. CUEVAS** (Madrid, Spain).
285 Squamous cell carcinoma of the ovary. Report of 6 cases.
- 16,45 - 17,00 **F. STENBÄCK** (Department of pathology, University of Kuopio, Finland).
286 Surface ultrastructure of papillary serous cystadenoma of the ovary: Biological, histogenetical and prognostical implications.
- 17,00 - 17,15 **J. MAS, E. RIVAS, E. ESTEVAN, R. VELA, A. ROBLEDO, H. OLIVA** (Dto. de Patología, Fundación Jiménez Díaz, Madrid, Spain).
287 Mesodermal tumor of Müllerian origin (papilar adenofibroma) in an uterus with leiomyomas and associated renal adenocarcinoma. Optic and ultrastructural study.
- 17,15 - 17,30 **M. J. RIOS MITCHELL, J. A. GIMÉNEZ MAS, G. GARCÍA JULIÁN, J. M. MARTÍNEZ PEÑUELA, J. M. RUIZ LISO, E. DÍAZ DE RADA** (Zaragoza, Spain).
288 Report of nine cases of rare Müllerian tumors, diagnosed in a period of two years.
- 17,30 - 17,45 **F. F. NOGALES, R. CARAPETO, R. GONZÁLEZ-CAMPORA, H. GALERA** (Hospital Clínico Universitario, Sevilla, Spain).
289 Strumal carcinoid associated with endometrial adenocarcinoma.
- 17,45 - 18,00 **T. GEORGIEV, S. SIVCHEV, I. VALKOV, Z. TAKEVA, S. DOKUMOV** (Department of Pathology, Medical Academy, Bulgaria, Sofia).
290 Clinicomorphological studies in different lesions of the human corpus luteum.

FRIDAY SEPTEMBER 21, 1979

09,00 - 13,00 hrs.

ROOM A

09,00 - 13,00 **PLENARY SESSION**

THYROID GLAND PATHOLOGY

Chairman: H. Galera (Sevilla, Spain).

Co Chairman: CHR. Hedinger (Zurich, Switzerland)

CHR. HEDINGER (Kantonsspital University, Zurich, Switzerland).

032 Geographic Pathology.

D. SERRÃO, V. GONÇALVES, M. A. SOBRINHO-SIMÕES (Laboratorio de Anatomia Patológica, Faculdade de Medicina, Porto, Portugal).

033 Auto-immune thyroiditis. A reappraisal with a particular emphasis on Hashimoto's disease.

CHR. BROWN (London Hospital Medical School, London, England).

034 Pathology of goitre.

J. V. JOHANNESSEN (Department Pathology, Norwegian Radium Hospital, Oslo, Norway).

035 Papillary and follicular carcinoma.

E. D. WILLIAMS (Welsh National School of Medicine, Cardiff, Wales, England).

036 Medullary carcinoma of the thyroid.

H. GALERA (Department Pathology, Hospital Clínico Universitario, Sevilla, Spain).

037 Anaplastic carcinoma.

B. CAILLOU (Department Pathology, Institut Gustave Roussy, Villejuif, France).

038 Malignant lymphoma.

09,00 - 13,00 WORKSHOP ON CYTOPATHOLOGY

Coordinator: **L. GALINDO** (Department of Pathology, Hospital de la Santa Cruz y San Pablo, Barcelona, Spain).

Speakers: **P. DE AGUSTÍN** (Department of Pathology, Section of Cytopathology, Ciudad Sanitaria "1.º de Octubre", Madrid, Spain).

P. DE LAS HERAS (Department of Pathology, Hospital de la Santa Cruz y San Pablo, Barcelona, Spain).

J. H. HOLZNER (Department of Pathology, University of Vienna, Austria).

R. MARTÍNEZ-CABRUJA (Department of Pathology, Hospital Central de la Cruz Roja, Madrid, Spain).

F. RIVAS-MANGA (Department of Pathology, Section of Cytopathology, Fundación Jiménez Díaz, Madrid, Spain).

W. WOLINSKA (Memorial Sloan-Kettering Cancer Center, New York, USA).

FREE PAPER SESSION 28: CHILDHOOD DISEASE I

Chairman: J. Colomer (Spain).

Co Chairman: A. Moragas (Spain).

- 09,00 - 09,15 **C. CAMARERO, A. RUIZ ELUA, F. J. ORTEGA ITUIÑO** (Las Arenas, Guecho, Vizcaya, Spain).
291 Milk and other food intolerances in children. Quantitative, morphometry of jejunal biopsy changes.
- 09,15 - 09,30 **W. RYD, B. KRISTIANSOON** (Department of Pathology, Sahlgren Hospital, Göteborg, Sweden).
292 Intestinal mucosa biopsies from infants with inadequate weight/length development.
- 09,30 - 09,45 **V. CUSI, A. ALONSO, J. VILA** (Barcelona, Spain).
293 Chronic gastritis in childhood.
- 09,45 - 10,00 **S. M. CHIARELLI, F. DONZELLI, V. TERRIBILE** (Istituto di Anatomia Patologica, Universita, Padova, Italy).
294 Pediatric jejunal biopsy.
- 10,00 - 10,15 **P. GARÍN CHESA, J. M. POLAK, C. M. TIMSON, M. G. BRYANT, S. R. BLOOM** (Royal Post-graduate Medical School, London, England).
295 Decreased somatostatin content in persistent neonatal hyperinsulinaemic hypoglycaemia.
- 10,15 - 10,30 **A. DE LOS RÍOS, M. SAN VICENTE, A. COTERO, A. ARROYOS** (Bilbao, Vizcaya, Spain).
296 Two autopsy cases of mucoviscidosis with long-standing neonatal jaundice.
- 10,30 - 10,45 **C. HIDALGO, M. P. PEÑA, A. RUIZ** (Madrid, Spain).
297 Correlation between pathological and bacteriological findings on newborn's autopsies.
- 10,45 - 11,00 **I. T. CALUSER, P. FLORESCU, L. CALUSER, A. PRIA** (Morphopathological Department of the Cluj-Napoca Medical School, Romania).
298 The morphopathological profile of the children's enteropathies studied on 210 intestinal endobiopsies.

FREE PAPER SESSION 29: CHILDHOOD DISEASE II

Chairman; W. A. Blanc (USA).

Co Chairman: A. Santos Briz (Spain).

- 11,15 - 11,30 **GY. DAUDA, M. VARGA** (Dept. Pathology, County Country Hosp., Nyiregyháza, Hungary).
299 The role of pulmonary hyaline membrane in the perinatal mortality.
- 11,30 - 11,45 **W. A. BLANC, A. C. MOESSINGER, J. BASSI, L. S. JAMES** (Columbia Presbyterian Medical Center, New York, USA).
300 Inhibition of fetal lung growth after amniocentesis.
- 11,45 - 12,00 **G. GROSSMANN, I. LARSSON, R. NILSSON, B. ROBERTSON, L. RYDHAG, P. STENIUS** (Dept. Pathology, Stockholm, Sweden).
301 Emulsified synthetic surfactant; surface properties and effect on neonatal lung expansion during artificial ventilation.
- 12,00 - 12,15 **A. RUIZ, J. M. VIGUER, J. CUEVAS, E. BURGOS** (Madrid, Spain).
302 The development of the terminal respiratory unit (TRU). Comparision between well developed and small for date preterm and newborn infants.
- 12,15 - 12,30 **E. PÉREZ-BECERRA, M. TORO, J. VARELA, J. FANEGO** (Department of Pathology, Medical Faculty, Santiago de Compostela, La Coruña, Spain).
303 Infantile hemangioendotheliomas of the liver.
- 12,30 - 12,45 **ZS. SCHAFF, J. TIMAR, K. LAPIS, I. KRAUSE** (Institute of Pathology of the Semmelweis Medical University, Budapest, Hungary).
304 Ultrastructural studies on neuroblastoma in childhood.
- 12,45 - 13,00 **R. N. LAURINI** (Department of Pathology, Nordland Sentralsykehus, Bodo, Norway).
305 Angio-Immunoblastic lymphadenopathy in childhod.

FREE PAPER SESSION 32: LYMPHOMAS I

Chairman: J. Diebold (France).

Co Chairman: J. Navas Palacios (Spain).

- 09,00 - 09,15 **D. STRAMIGNONI, A. STRAMIGNONI** (Istituto di Anatomia Patologica, Torino, Italy).
323 Reed-Sternberg-like cell in germinal centers and non-Hodgkin's lymphomas.
- 09,15 - 09,30 **G. MARCHAL, M. REYNERS, E. MRENA, V. PACZYNSKI, J. DIEBOLD** (Lab. Path. Thuin, Belgium and Hotel Dieu, Paris, France).
324 Ultrastructural and immunocytochemical study of Reed Sternberg cells in Hodgkin's disease.
- 09,30 - 09,45 **M. J. FORJAZ DE LACERDA, J. M. FORJAZ DE LACERDA.**
(Inst. Path. Fac. Med. Lisboa, Portugal).
325 Siderosis in Hodgkin's disease.
- 09,45 - 10,00 **J. J. NAVAS PALACIOS, M. D. VALDÉS, M. A. MONTALBÁN, C. ORTIZ** (Madrid, Spain).
326 Lymphoblastic lymphoma/leukemia of T cell origin: Ultrastructural, cytochemical and immunological features of ten cases.
- 10,00 - 10,15 **N. BOURGEOIS, N. BUYSENS** (U.I.A. Antwerp, Belgium).
327 The changing pattern of follicular lymphoma.
- 10,15 - 10,30 **P. LENNER, E. LUNDGREN** (Department of Oncology, University of Umea, Sweden).
328 Non-Hodgkin's lymphoma stages I and II. A retrospective study using the Lukes-Collins classification.
- 10,30 - 10,45 **J. VARELA-DURÁN, C. BLOOMFIELD, G. FRIZZERA** (Minneapolis, USA).
329 Nodular lymphoma. A study of the morphologic features influencing prognosis bases on the clinicopathologic analysis of 57 patients with successive biopsies.
- 10,45 - 11,00 **E. LUNDGREN, P. LENNER, L. DAMBER** (Department of Pathology, University of Umea, Sweden).
330 The clinical and prognostic significance of growth pattern in non-Hodgkin's lymphoma classified according to Lukes and Collins.

FREE PAPER SESSION 33: LYMPHOMAS II

Chairman: J. Forteza Vila (Spain).

Co Chairman: J. Haot (Belgium)

- 11,15 - 11,30 **A. HERRERO ZAPATERO, I. RIESGO** (Oviedo, Spain).
331 Idiopathic acquired hypogammaglobulinemia, intestinal lymphoid nodular hyperplasia and generalized amyloidosis. A case report.
- 11,30 - 11,45 **F. HALALAU** (Victor Babes Institute, Bucharest, Romania).
332 The histological distinction between reactive follicular hyperplasia and follicular lymphoma.
- 11,45 - 12,00 **C. MARTÍN, M. L. DE LA PEÑA, J. BLANCO, A. ACEVEDO** (Madrid, Spain).
333 Castleman disease. A clinicopathological study of four cases.
- 12,00 - 12,15 **J. BELLASSAI, H. NOEL, J. HAOT** (Anatomie Pathologique, Clinique Universitaire St. Luc, Bruxelles, Belgium).
334 Histopathological and immunocytological study of a serie of gastrointestinal lymphomas.
- 12,15 - 12,30 **A. BAJTAI, I. SZANTO, L. SIMON, I. A. FIGUS** (Dep. Path. Anat., and 2nd. Surg. Clinic., Postgrad. Med. School, Budapest and Dep. Gastroenterology, Town Council Hosp., Jászberény, Hungary).
335 Some observationes on gastric lymphomas.
- 12,30 - 12,45 **K. O. FRANSSILA** (Department of Pathology, University of Helsinki, Finland).
336 Coincidence of hair cell leukemia and malignant lymphoma. A case report.
- 12,45 - 13,00 **M. J. FORJAZ DE LACERDA, J. M. FORJAZ DE LACERDA** (Lisboa, Portugal).
337 Nodular lymphoma in a married couple.

FRIDAY SEPTEMBER 21, 1979

14,00 - 18,15 hrs.

ROOM A

14,00 - 16,00 SLIDE SEMINAR ON ORAL PATHOLOGY

Coordinator: **V. NAVARRO** (Department of Pathology, Centro Especial Ramón y Cajal, Madrid, Spain).

Rapporteurs: **R. B. LUCAS** (Department of Pathology, Royal Dental Hospital of London, School of Dental Surgery, London, England).

G. SEIFERT (Pathologisches Institut der Universität Hamburg, Germany).

16,15 - 18,15 SLIDE SEMINAR ON SURGICAL PATHOLOGY

Coordinator and Rapporteur: **J. ROSAI** (Department of Anatomic Pathology, Medical School, University of Minnesota, USA).

18,30 hrs. GENERAL ASSEMBLY OF THE SPANISH SOCIETY OF PATHOLOGY.

14,00 - 17,45 SCIENTIFIC SESSION

LUNG PATHOLOGY IN INTENSIVE CARE UNITS

Chairman: E. Álvarez Fernández (Madrid, Spain).

Co Chairmen: H. Spencer (London, England).

J. M. Lauweryns (Leuven, Belgium).

C. MITTERMAYER, U. N. RIEDE (Pathologisches Institut, Freiburg, Germany).

068 Functional pathology of human shock-lung.

P. FERNÁNDEZ SEGOVIANO (Madrid, Spain).

069 Shock lung in peritonitis.

M. PIAZZA (Istituto di Anatomia Patologica, Università, Padova, Italy).

070 Pathology of perfusion lung.

V. CHULIÁ, A. LLOMBART-BOSCH, A. PEYDRÓ-OLAYA, M. LLEDÓ (Hospital Clínico Universitario, Valencia, Spain).

071 Experimental unilateral lung flooding. A functional and ultrastructural study.

P. DALQUEN (Pathologisches Institut der Universität, Basel, Switzerland).

072 Lung in shock and intensive care: clinico-pathological correlations.

H. SPENCER (Department of Morbid Anatomy, St. Thomas's Hospital Medical School, London, England).

073 Respiratory infections in intensive care units.

J. M. LAUWERYNS (Katholieke Universiteit Leuven, Belgium).

074 Pathology and spontaneous evolution of neonatal hyaline membrane disease.

A. RUIZ (Madrid, Spain).

075 Pathology of bronchopulmonary dysplasia.

V. RONA (Departamento de Anatomía Patológica, Ciudad Sanitaria Francisco Franco, Madrid, Spain).

076 Vascular lesions in endotoxic shock of childhood.

FREE PAPER SESSION 30: CHILDHOOD DISEASE III

Chairman: A. Herrero Zapatero (Spain).

Co Chairman: J. Visser (Holland).

- 14,00 - 14,15 **R. FERNÁNDEZ ESPINO, M. ARTEAGA MARTÍNEZ, C. GONZÁLEZ PORTAL** (Centro Especial Ramón y Cajal, Madrid, Spain).
306 Ebstein's malformation. A morphological study and its possible pathogenesis.
- 14,15 - 14,30 **J. PLANK** (Dpt. Pathology, Komensky University, Martin, Czechoslovakia).
307 The morphologic criteria of newborn's maturity.
- 14,30 - 14,45 **C. PÉREZ SÁNCHEZ, C. GAMALLO, F. LÓPEZ BAREA, J. GUERRERO** (Madrid, Spain).
308 Shwachman's syndrome.
- 14,45 - 15,00 **J. W. VISSER** (Laboratorium Volksgezondheid, Leeuwarden, Holland).
309 "Sudden infant death syndrome" and endocrine lesions.
- 15,00 - 15,15 **M. FRESNO, M. GONZÁLEZ, E. FUENTE, C. MARTÍNEZ** (Ciudad Sanitaria N. S. de Covadonga, Oviedo, Spain).
310 Congenital syphilis. A study of two cases with autopsy.
- 15,15 - 15,30 **J. M. GOKEL** (Pathol. Inst. Univ. München, Germany).
311 The squamous metaplasia in the foetal and neonatal human prostate. A light microscopic and fine structural analysis.
- 15,30 - 15,45 **J. MARTÍNEZ-PEÑUELA, J. RAZQUIN, A. PURAS, P. LLORENTE, A. DELGADO, J. EGUES** (Pamplona, Spain).
312 Severe and lethal chondrodystrophies of the newborn.
- 15,45 - 16,00 **M. L. PICAZO, J. I. RODRÍGUEZ, M. A. PEÑA, M. NISTAL, T. TUÑÓN** (Madrid, Spain).
313 Male pseudohermaphroditism, nephrotic syndrome and Wilms tumor.
- 16,00 - 16,15 **J. CUEVAS, C. GAMALLO, A. RUIZ, J. I. RODRÍGUEZ, J. M. FERREIROS, G. CORDOBILLA** (Madrid, Spain).
314 Morphologic findings in the low cardiac outflow syndrome.

FREE PAPER SESSION 31: SOFT TISSUE TUMOURS

Chairman: B. Bednar (CSSR).

Co Chairman: A. Huaman (USA).

- 16,30 - 16,45 **M. LECONA, M. C. CARRASCO** (Ciudad Sanitaria Prov. Fco. Franco, Madrid, Spain).
315 Ultrastructure of mesenchymal synovial sarcoma.
- 16,45 - 17,00 **G. SIMU, E. MACAVEI** (Department of Pathology, TG. Mures, Romania).
316 Histologic observation during malignant transformation in a case of inflammatory fibrous histiocytoma.
- 17,00 - 17,15 **M. CANEPA, A. GAGLIO, I. MINUTO** (Imperia, Italy).
317 Importance of microfilaments in the diagnosis of mesotheliomas.
- 17,15 - 17,30 **T. G. MIRALLES, C. LOBOZ, V. S. FOLGUERAS, S. CAPEROS** (Department of Pathology H. G. A. Oviedo, Spain).
318 Immunocytochemic staining with the P.A.P. (peroxidase antiperoxidase) as help in the diagnosis of soft tissue sarcomas.
- 17,30 - 17,45 **B. HAGMAR, L. ANGERVALL, L. G. KINDBLOM, B. MAGNUSSON, C. MERCK, J. SÄVE-SÖDERBERGH** (Department of Cytology, Sahlgrenska Hospital, Göteborg, Sweden).
319 Aspiration cytology of malignant fibroblastic histiocytic tumours in correlation to light and electron microscopy and histochemistry.
- 17,45 - 18,00 **M. NISTAL, F. CERMEÑO DE GILES, R. PANIAGUA, M. L. PICAZO, J. L. RAMOS GUERREIRA** (Ávila, Spain).
320 Malignant granular cell tumor originated from vascular leiomyosarcoma.
- 18,00 - 18,15 **J. VARELA-DURÁN, H. OLIVA, J. ROSAI** (Minneapolis, U.S.A.)
321 Vascular leiomyosarcoma. The malignant counterpart of vascular leiomyoma.
- 18,15 - 18,30 **B. BEDNÁR, M. ELLEDER** (Hlava Institute of Pathology, Prague, CSSR).
322 Electron Microscopy and histochemistry of Langerhans cells in histiocytosis X and related histiocytoses.

FREE PAPER SESSION 34: LYMPHOIDE AND MACROPHAGE DISEASE

Chairman: M. Wolman (Israel).

Co Chairman: A. Sampedro (Spain).

- 14,00 - 14,15 **M. CARBALLAL-LUGRIS, A. GARCÍA-LIMESES, R. PARDAVILA** (Residencia Sanitaria Montecelo, Pontevedra, Spain).
337b Epithelioid germinal centers in the human spleen.
- 14,15 - 14,30 **M. J. ALAVAIKKO, A. UOTILA, K. KROHN, P. KARMA** (Tampere Central Hospital, Dept. Path., Finland).
338 Distinguishing two cell populations for DNA cytofluorometry of lymphoid cells by use of simultaneous E-rosette formation.
- 14,30 - 14,45 **M. REYNES, V. PACZYNSKI, F. CAPRON, M. GALTIER, J. DIEBOLD** (Lab. Path. Hotel Dieu, Paris, France).
339 Demonstration of free and E.R. bound ribosomal immunoglobulin synthesis in neoplastic and normal human immunoblasts. An ultrastructural and immunocytochemical study.
- 14,45 - 15,00 **M. WOLMAN** (Department of Pathology, Tel-Aviv University Sackler School of Medicine, Tel-Aviv, Israel).
340 Heterogeneous nature of macrophage activation.
- 15,00 - 15,15 **G. MIKUZ, G. HOINKES, A. PROPST, P. WILFLINGSIEDER** (Pagologisches Institut der Univ. Innsbruck, Austria).
341 Phagocytosis and intracellular decomposition of silicon rubber. (Ultramicroscopic and microchemical findings).
- 15,15 - 15,30 **K. DANESHOD** (Pathology Department, Medical School, Shiraz University, Shiraz, Iran).
342 Localized granulomatous lymphadenitis due to leishmania Donovanii.
- 15,30 - 15,45 **J. WUSTROW, W. GROETSCH, M. BERGHOLZ, G. R. F. KRUEGER, R. FISCHER** (Immunopathology Laboratories, Pathology Institute University of Cologne, Germany).
343 Persistence of rubella virus antigen in lymphoid tissues of patients with immunoblastic lymphadenopathy.
- 15,45 - 16,00 **T. ZEBRO, R. A. BHUTTA** (Department of Pathology, Pahlavi University Medical School, Shiraz, Iran).
344 Morphometric evaluation of lymph node vessels in malignant and benign conditions.

FREE PAPER SESSION 35: LYMPHOID AND THYMIC DISEASE

Chairman: R. Báguena (Spain).

Co Chairman: M. Maillet (France)

- 16,15 - 16,30 **I. M. DE SOLÁS RAFECAS, F. C. MARTÍNEZ UBEIRA, B. J. REGUEIRO GARCÍA, J. FORTEZA VILA** (Servicio de Anatomía Patológica, C. S. "Juan Canalejo", La Coruña, Spain).
345 Correlation between surface charge and cellular ultrastructure of murine lymphoma P₁₇₉₈
- 16,30 - 16,45 **R. RICCO, V. PESCE DELFINO** (Bari, Italy).
346 Reactive versus tumoral lesions in lymph nodes: Lymphocytes histiocytes relationship in murine parabiosis.
- 16,45 - 17,00 **H. KOZLOWSKI, M. HRABOWSKA** (Departments of Pathology, Inst. Obstetrics Gynec., Gdansk, Poland).
347 Stages of development of immunologic response in the regional lymph nodes draining female genital tract cancer.
- 17,00 - 17,15 **J. ALBA, A. ABAURREA, G. FONTÁN, M. C. RODRÍGUEZ** (Madrid, Spain).
348 Histological thymus patterns in severe combined immunodeficiency.
- 17,15 - 17,30 **M. A. DINA, M. PIANTELLI, L. LAURIOLA, A. CARBONE, P. MUSIANI** (Pathology Dept. Catholic University, Roma, Italy).
349 Lymphocyte subpopulations in non-neoplastic pathologic conditions of the thymus.
- 17,30 - 17,45 **J. CALAP CALATAYUD, A. CASTELLS RODELLAS** (Valencia, Spain).
350 Scanning electron microscop study of the chicken bursa and chicken thymocytes.
- 17,45 - 18,00 **M. ZLATEVA, E. SOFTOVA** (Department of Pathology, Medical Academy, Sofia, Bulgaria).
351 The condition of lymph tissue in rats treated with pesticides.
- 18,00 - 18,15 **A. A. ABRAHAM** (Department of Pathology, George Washington University, Washington D.C., USA).
352 Coxsackie B5 virus infection with pancreatic isletitis and humoral immune response in thymus.
- 18,15 - 18,30 **M. D. LUDENA, J. FARIÑA, J. BALIBREA, J. PONSETI, M. MERCHÁN, P. ARAGONCILLO** (Madrid, Spain).
353 Thymus ultrastructure in miastenia gravis.

POSTER SESSION : MISCELLANEOUS

E. ÁLVAREZ-FERNÁNDEZ (Ciudad Sanitaria Prov. Feo. Franco, Madrid, Spain).

354 The role of fibrosis in the small airways in centrilobular emphysema.

W. ROMEN, A. RUTER, M. HAUCKE (Path. Institut, Würzburg, Germany).

355 Preneoplastic nuclear alterations of the rat's liver. A computer aided cytophotometric analysis.

LJ. GROZDEV (Institute of Pathology, Medical Faculty, Skopje, Yugoslavia).

356 Histologic and Immunohistochemic characteristics of primary gastric lymphoma and pseudo-lymphoma.

H. P. ROHR (Institute of Pathology, University of Basel, Basel, Switzerland).

357 Microcomputer assisted teaching in pathology (microcat).

H. P. ROHR, G. BARTSCH (Institute of Pathology, University of Basel, Switzerland).

358 Light and electronmicroscopic stereological analysis of the normal human prostate and of human benign prostatic hyperplasia.

J. W. VISSER (Leeuwarden, Holland)

"Sudden infant death syndrome" and endocrine lesions.

M. J. MIHATSCH, F. GLOOR, J. TORHORST, H. O. HOFER, H. U. SOLLINGER (Institutes of Pathology Basle and St. Gallen, Switzerland)

READ BY TITTLE

H. P. ROHR (Institute of Pathology, University of Basel, Switzerland).
359 Optomanual imagen analysis (bit pad - TRS 80).

H. P. ROHR, A. SCHMASSMANN, G. MIKUZ, G. BARTSCH (Institute of Pathology, University of Basel, Switzerland).
360 Integrated spermiometrics, A new complement to diagnostic andrology.

J. M. POLAK, A. E. BISHOP, M. G. BRYANT, S. R. BLOOM (Royal Postgraduate Medical School, London, England).
361 The morphology of vip nerves in inflammatory bowel disease.

J. M. POLAK, A. M. J. BUCHAN, M. G. BRYANT, C. M. TIMSON, S. R. BLOOM (Royal Postgraduate Medical School, London, England).
362 Intestinal gastrin. Ontogeny and tumour distribution.

J. M. POLAK, C. M. TIMSON, P. GARÍN CHESA, S. R. BLOOM, M. G. BRYANT, S. J. MITCHELL, A. G. E. PEARSE (Royal Postgraduate Medical School, London, England).
363 Retrospective ultrastructural studies of secretory granules in vipomas.

SCIENTIFIC EXHIBITION

There will be commercial exhibits of books, instruments and medical apparatus in the Exhibition Room on the ground floor. The Exhibition will be officially opened on Monday, 10.30 Hrs, by the President of the European Society of Pathology.

PLAN OF TRADE EXHIBITION

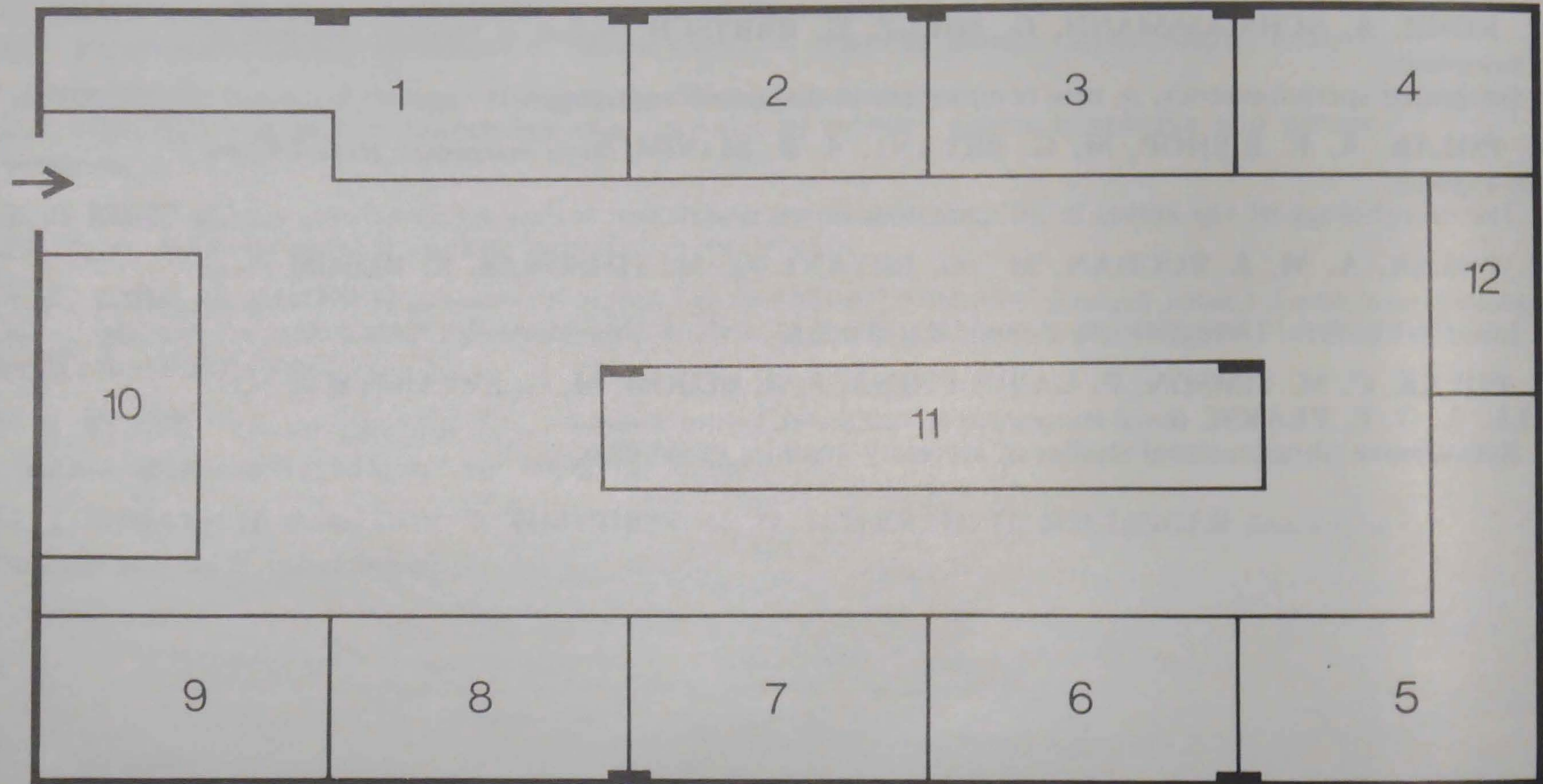

LIST OF EXHIBITORS:

- STAND N° 1 CASA ALVAREZ (MADRID)
STAND N° 2 REICHERT OPTISCHE WERKE A.G.
(AUSTRIA)
STAND N° 3 GIRALT, S. A. (MADRID)
STAND N° 4 TECHNICON (MADRID)
STAND N° 5 REGO Y CÍA, S. A. (MADRID)
STAND N° 6 y 7 DIVISIÓN LAB-TEK MILES-MARTÍN (MADRID)

- STAND N° 8 ZEISS IBÉRICA (MADRID)
STAND N° 9 DIGITAL (MADRID)
STAND N° 10 GUSTAV FISCHER VERLAG
(STUTT GART, GERMANY)
STAND N° 11 GARCÍA MUÑOZ (VALENCIA)
STAND N° 12 ABSER (MADRID)

SOCIAL PROGRAMME

<i>SUNDAY 16 SEPTEMBER</i>	19,30 - 20,30	Informal Welcoming Reception at the Hotel of the Convention Center.
<i>MONDAY 17 SEPTEMBER</i>	20,00 - 21,30	Official Reception at the University: Cocktail given by the Authorities.
<i>TUESDAY 18 SEPTEMBER</i>	18,30 - 22,30	Paella-Party at the Devesa Gardens. — With Bull-ring entertainment. — Typical buffet with paella. — Spanish folk dancing.
<i>WEDNESDAY 19 SEPTEMBER</i>		FREE
<i>THURSDAY 20 SEPTEMBER</i>	20,00 - 21,30	Concert organised by the Aula de Cultura de la Caja de Ahorros de Valencia, at the Church of the Patriarca.
<i>FRIDAY 21 SEPTEMBER</i>	21,30 - 24,00	Optional Dinner-Dance at the Monte-Picayo Casino (maximum 300 persons).

All events are included in the Registration Fees for Delegates and Accompanying Persons. Only the Dinner-Dance is not included; for this optional dinner, tickets are available at the Secretariat.

A limited number of tickets for each event can be purchased at the Secretariat for those not registered in the Congress.

Tickets will be required for all Social events.

LADIES AND ACCOMPANYING PERSONS PROGRAMME

MONDAY 17 SEPTEMBER

9,30 - 12,30

CITY TOUR

Visits to some of the most important Gothic art monuments; the Cathedral, Towers of Serrano and Towers of Cuarte, the Lonja de la Seda, and the former Cloister of St. Domingo. Also visits to later barroque and neo-classic monuments.

16,30 - 18,00

NATIONAL CERAMICS MUSEUM

The most important in Spain for its collection of ceramic art from, principally, Paterna, Manises and Alcora. Situated in a beautiful barroque palace, the main entrance of which was sculpted by Ignacio Vergara out of alabaster marble (XVIII Century).

TUESDAY 18 SEPTEMBER

9,30 - 12,30

BELLAS ARTES MUSEUM

Contains a very valuable collection of medieval paintings, especially XV Century, and includes the works of Juan de Juanes, Ribalta, Murillo, Velasquez, Goya, Vicente Lopez, Sorolla and Pinazo. Contemporary art is also featured.

WEDNESDAY 19 SEPTEMBER

9,30 - 18,00

EXCURSION TO PEÑISCOLA AND SAGUNTO

Peñiscola: Interesting remains of the medieval fortress (known as the Castle of Papa Luna, one of the anti-Popes) and situated amidst beautiful surroundings.

Swim and lunch at the sea-side, Hotel RAMADA-PAPA LUNA

Sagunto: An historical city, important since ancient Iberian times, but more so in the Roman epoch. Retains a lovely old theatre with magnificent acoustics, a prominent fort atop the dominating hill, and ruins of the ancient Roman public city. The site was also fortified in Napoleonic times. Once a strategic point of the first order for the defense of and access to Valencia.

<i>THURSDAY 20 SEPTEMBER</i>	9,30 - 12,30	“COSTA DEL AZAHAR” EXCURSION (ORANGE BLOSSOM COAST) By the coast road to Cullera and Gandia. Swim and lunch at the sea-side, Hotel BAYREN.
<i>FRIDAY 21 SEPTEMBER</i>	9,30 - 12,30	Visit to a Ceramic Factory and Garden Center.

All the events above are included in the Registration Fees for Accompanying Persons.

A limited number of tickets for each event are available for purchase at the Ladies' Desk at the Secretariat for those who are not registered as Accompanying Persons.

Tickets will be required for all Social events.

GENERAL INFORMATION

LOCATION

Convention Center of the Ilustre Colegio Oficial de Médicos (I.C.O.M.). Avenida de la Plata, Valencia.
Telephone number 334 87 08

RECEPTION & SECRETARIAT DESK

Located on the first floor of the Convention Center and open throughout the Congress to deal with enquiries as well as for distribution of document folders, mail and messages.

Open during the following hours:

Sunday 16	15,00 - 19,30
Monday 17 through Friday 21	8,30 - 18,00

LANGUAGES

The Official languages of the Congress will be English and Spanish. Simultaneous translation will be provided for Plenary and Scientific Sessions and Slide Seminars as well as for Short Courses and Workshop. Free Papers may be presented in any official language of the European Society of Pathology (French, German, Italian, Spanish) but no simultaneous translation will be available.

IDENTIFICATION TAGS

All Delegates and Accompanying persons are requested to wear their name tags at all times. If not, admittance to sessions and social events will not be permitted.

Color code:

- Orange -Organising Committee
- Blue - Delegates
- Yellow - Accompanying persons
- Yellow with black stripe - Exhibitors

MAIL AND MESSAGES

A message board will be located next to the Secretariat, first floor.

TRANSPORTATION

The Congress Organisation will provide daily shuttle service to all sessions and social events from congress-appointed hotels. Bus time-table is included in your document case.

SLIDES

Slides must be delivered one day before presentation in the Slide Room on the first floor of the Convention Center. Projection facilities will be provided for metal, plastic or cardboard mounted 35 mm (5×5) transparencies only. Slides must be numbered in projection sequence. Thumb-spot all slides in the lower left corner so that they read correctly on hand viewing.

POSTERS

Congress hostesses will provide panels to arrange the posters, but each delegate will have to place his poster himself. Therefore it is advisable to use Sunday afternoon or Monday morning before the beginning of the Sessions.

MICROSCOPE ROOM

A microscope room will be available to all participants throughout the Congress.

SLIDE SEMINARS, SHORT COURSE OF ELECTRON MICROSCOPY

Participants registered for Slide Seminars and Short Course of Electron microscopy will find a ticket in their personal envelope. They will have a reserved area in the room.

All delegates can attend the Slide Seminars and Short Course depending on the availability of seats.

Throughout the week participants can study the slides in the microscope room.

Some Slide Seminars are available for sale at the Secretariat, on a first-come-first-served basis.

WORKSHOP ON CYTOPATHOLOGY

Registrants will receive material and general instructions at the beginning of the Congress.

COFFEE BREAKS

Coffee and tea will be served daily in the Hall of the Hotel of the Convention Center and in the Restaurant (Free of charge).

On Monday from 10,00 to 11,00 and from 16,30 to 17,00 Hrs
Tuesday to Friday from 10,30 to 11,30 and from 16,00 to 16,30 Hrs

BUFFET-LUNCHEONS

The Bar of the Hotel will be open daily.

As only one hour is scheduled for lunch, the Organising Committee offers the following suggestions:

- 1 A limited number can be served at the restaurant of the Hotel during the whole week. Delegates wishing to use this facility are kindly requested to buy the tickets (3,000 Pts for the 5 Lunches from Monday to Friday) at the Secretariat Desk.
- 2 The Student Hostal "Colegio Mayor Santa María" will serve lunch for those delegates interested (from Monday to Friday) at the low price of 1,500 Pts. A bus service will operate between the Congress area and the Student Hostal at lunch time.
- 3 Meals can also be had in a number of small, inexpensive bars near the Congress area. These bars will display a Congress poster at their entrances.

SOCIAL PROGRAMME

All enquiries will be dealt with at the Secretariat, first floor. For details of departure points and times please consult your bus time-table and the announcements in the Hall of the Convention Center.

Tickets will be required for all social events.

ACCOMPANYING PERSONS

All enquiries will be dealt with at the Ladies' Information Desk, first floor at the Secretariat.

For details of departure points and times, please consult your bus time-table for each event. Tickets will be required for each event.

DRESS

Informal for all occasions. Average temperature is 22-24° C. A jacket or light coat for possible cool evenings.

HOTEL ACCOMMODATION

The officially appointed travel agency VIAJES MELIA will have a Hospitality Desk, for the convenience of all participants, on the first floor for all information and services concerning accommodation, travel, optional sightseeing tours, etc.

Open during the following hours:

Sunday 16	15,00 - 19,30
Monday 17 through Friday 21	8,30 - 18,00

Viajes Melia town office is at:

Plaza del Caudillo, 12

Telephone 322 88 29

Open every day from 9,30 to 13,30 and from 16,30 to 20,00 (Saturday afternoon and Sunday closed).

BANK

The Caja de Ahorros de Valencia will be located on the first floor.

Open during the following hours:

Sunday 16	16,00 - 19,30
Monday 17 through Friday 21	8,30 - 18,00

Please note that bank are open from 9,00 to 14,00 Hrs daily, except Sunday.

PHOTOGRAPHERS 'S SERVICE

Mr. MARCO (Optica Vicente, Cirilo Amoros, 22) has been appointed official photographer. Photographs will be on display and for sale in the Convention Center, one day following respective events.

POST OFFICE

A post office counter will be situated in the Hall of the Convention Center.

COOPERATIVE STORE

Next to the Convention Center, in the Congress area, for members of the Colegio Oficial de Médicos, but open to delegates and Accompanying persons (supermarket, clothing, presents, souvenirs, etc... at very reasonable prices). Open during the following Hours:

Monday to Saturday 9,30 - 14,00 and 16,30 - 20,00
(Saturday afternoon closed)

MEDICAL & DENTAL ASSISTANCE

Contact the Secretariat on the first floor.

SHOPS & DEPARTMENT STORES

Department stores in Spain are usually open from 10,00 - 20,00 hrs including Saturdays and shops from 9,30 - 13,30 hrs and again from 16,30 - 20,00 hrs (closed on Saturday afternoon).

Appointments for hairdresser can be made by contacting the Ladies 'Desk 24 hours in advance.

TELEPHONES

Telephone booths for local and long distance calls are located in the Hall of the Hotel, next to the Congress rooms.

ACKNOWLEDGEMENTS

For their help in sponsoring the Congress, the Organisers wish to thank the following entities:

- *Ministerio de Universidades e Investigación.*
- *Ministerio de Asuntos Exteriores.*
- *Ministerio de Cultura.*
- *Ministerio de Comercio y Turismo.*
- *Ministerio de Sanidad y Seguridad Social.*
- *Asociación Española contra el Cáncer y Fundación Científica (Madrid).*
- *Universidad de Valencia.*
- *Excma. Diputación Provincial (Valencia).*
- *Excma. Alcaldía de Valencia.*
- *Excmo. Colegio Oficial de Médicos (Valencia).*
- *Junta provincial de la Asociación contra el Cáncer (Valencia).*
- *Fundación del Instituto Valenciano de Oncología.*
- *Caja de Ahorros de Valencia.*
- *Gustav Fischer Verlag.*
- *Bayer A.G. (Leverkusen).*

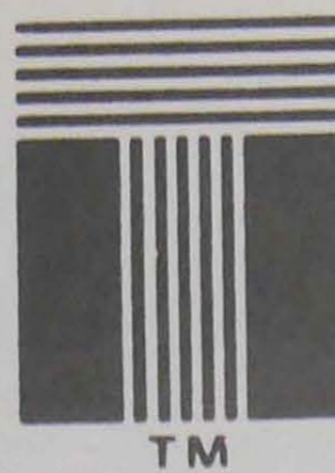

Technicon España, S. A.

LLANOS DE JEREZ, 2 - POL. IND. DE COSLADA
MADRID - TEL. 671 04 50

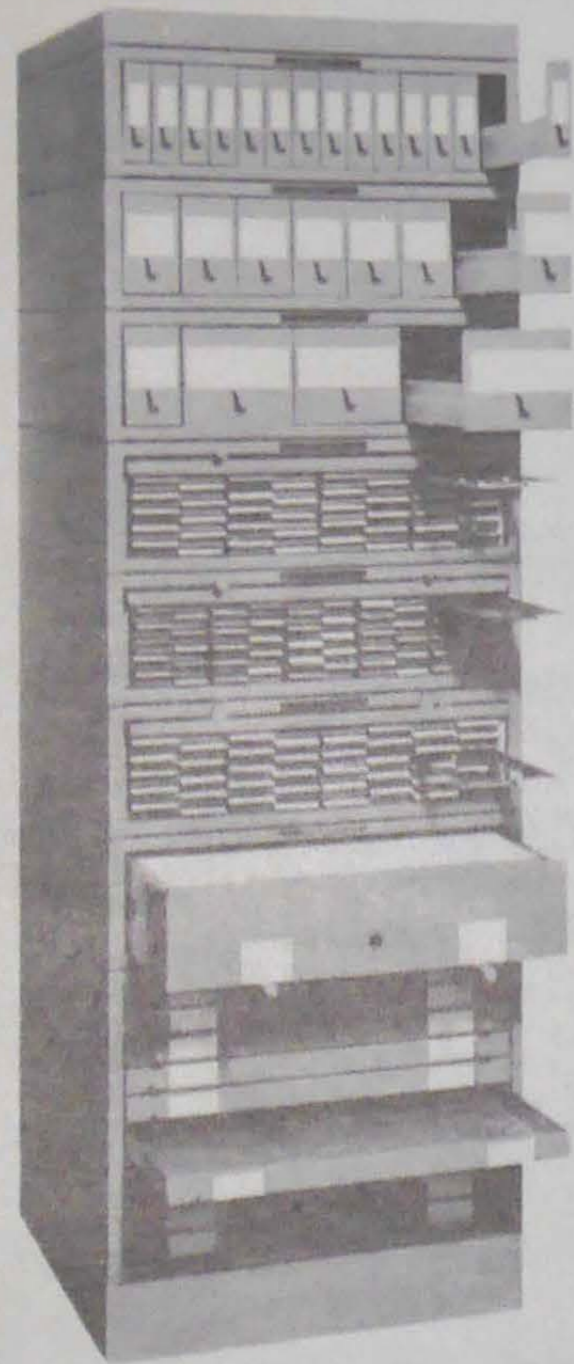

LAB-AID

Filing for:
Microslides
Kodchrome
Lantern slides
Parafin blocks

Illumination drawer
Flat filing

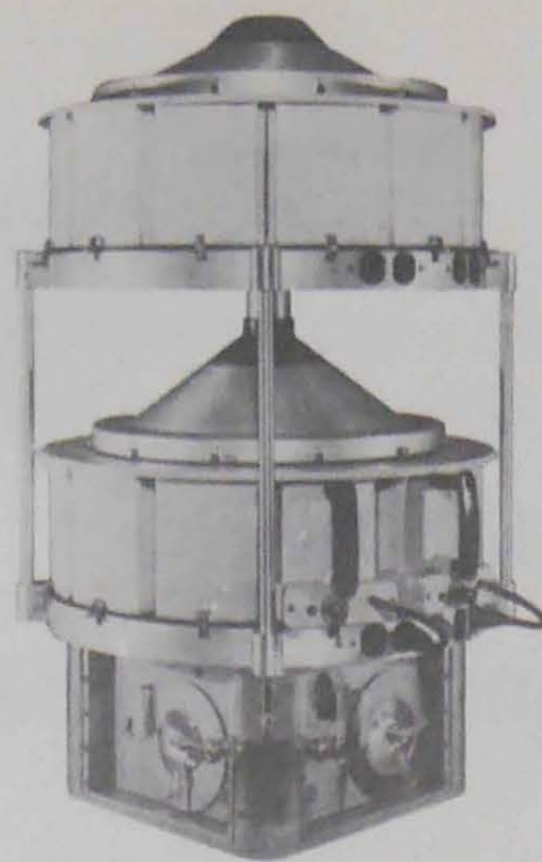

A.T. Duo

A.T. Mono

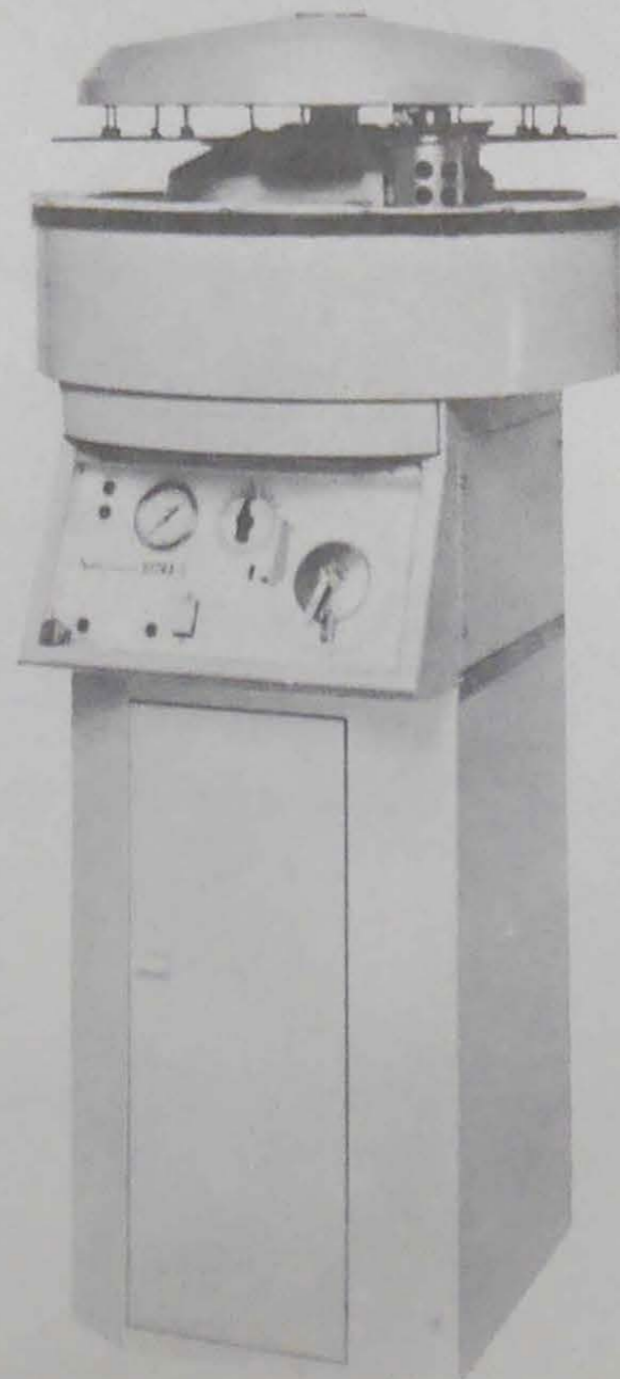

A.T. ULTRA - II

Microslide Dryer
Flotation Bath

Fixative
Dehidrant S-29

Clearing Agent
Paraplast (embedding medium)
Mounting medium
Deparaffinizing solvent
Histologic stains



ISI

INTERNATIONAL SCIENTIFIC INSTRUMENTS WORLDWIDE ORGANIZATION

Welcomes you to the

VIIth. European Congress of Pathology Valencia September 17-21

No other company in the world has such a wide range of SEMs to meet the microscopist requirements. Seven models from 120 Å to 30 Å. And now introducing a new concept of tool for Diagnostic Pathology. The LEM-2000 model combines light and electron optics in a single instrument.

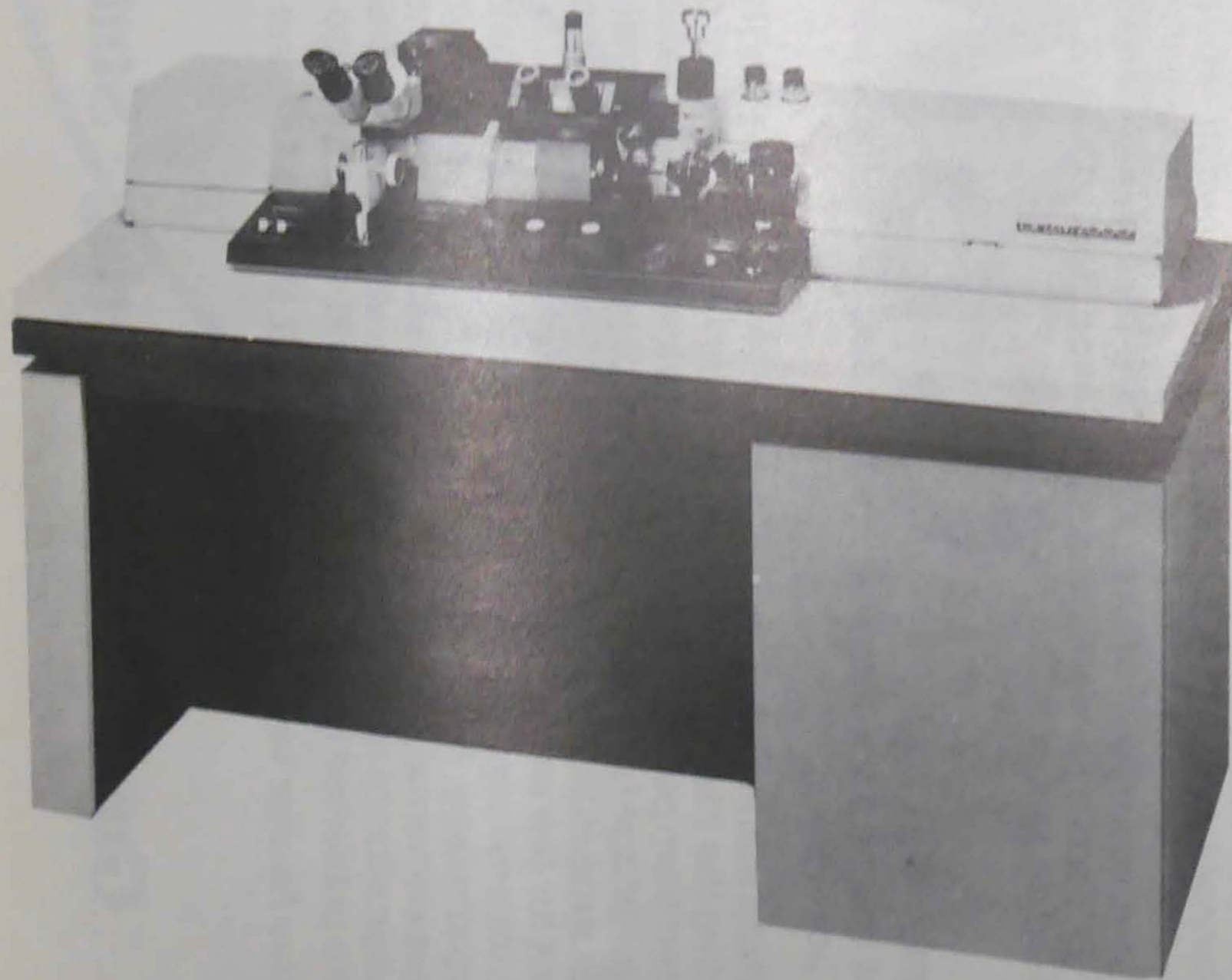

- 100 Kv. electron optics.
- Magnification range.
50x LM to 45.000x in TEM mode.
- Microprocessor based stage. Up to 100 positions to be recalled.
- $\pm 15^\circ$ stereo tilt in EM mode.
- Extra large 7 mm. grid.
- 35 mm. photographic fully automatic system either in LM or TEM.
- Fully automatic high vacuum system.
- Instant LM-TEM comparison of same areas of the sample.
- See it working in our Stand, or ask for a demo in your Country to ISI. You will be surprised of its performance and price.

IN SPAIN PLEASE CONTACT:

ISI ESPAÑA S. A. Playa de Louro, 1 VILLALBA (Madrid)
phone 91 - 850 20 94.

Mr. E. Romero

telex 46876 ISI E.

IN ANY EUROPEAN COUNTRY:

Please contact ISI offices. They will be glad to help you.

Pathology

Research and Practice

Special price of US \$ 63.- per volume to the members of the European Society of Pathology
Sample copies available

Formerly: Beiträge zur Pathologie
Official Journal of the European Society of Pathology

Founded by E. Ziegler (1886). Continued by L. Aschoff and F. Büchner.

Editors

W. Sandritter, Freiburg i. Br. (executive editor) · K. Bensch, Stanford, Calif./USA · E. H. Betz, Liège/Belgium · G. Dhom, Homburg/Saar · P. Dustin, Bruxelles/Belgium · L. E. Feinendegen, Jülich · S. Fujita, Kyoto/Japan · E. Grundmann, Münster i. W. · W. Jones-Williams, Cardiff/U. K. · K. Küchemann, Leverkusen · C. Nezelof, Paris/France · G. W. Richter, Rochester, N. Y./USA · H. P. Rohr, Basel/Switzerland · L. D. Stoddard, Augusta, Ga./USA · C. Thomas, Marburg · B. F. Trump, Baltimore, Md./USA · H. U. Zollinger, Basel/Switzerland · U. N. Riede, Freiburg i. Br. (assistant to the editors)

Advisory board

A. Eskenasy, Bucharest/Romania · A. Giordano, Milano/Italy · J. Groniowski, Warszawa/Poland · J. H. Holzner, Vienna/Austria · B. Ivemark, Stockholm/Sweden · H. Jellinek, Budapest/Hungary · J. V. Johannessen, Oslo/Norway · V. Karabela-Bouropoulou, Athens/Greece · M. Knezevic, Zagreb/Jugoslavia · A. Llombart-Bosch, Valencia/Spain · S. Poulsen, Copenhagen/Denmark · E. A. Saxén, Helsinki/Finland · D. Serrão, Porto/Portugal · H. Simon, Berlin/DDR · Z. Šoustek, Dobruška/ČSSR · A. J. M. van Unnik, s'Hertogenbosch/The Netherlands

1979. Volume 165-166

Publication: 4 issues per volume in irregular sequence. Price per volume DM 230,- (approx. US \$ 128.-) plus postage.

The journal which was founded as "Beiträge zur Pathologie" in 1886 has steadily pursued the essential goal of providing the international foundation for the entire field of pathology. All aspects of this field are represented from pure theory to daily practice. The title is realistic, and reflects the role of pathology, as a major bridge between research and practice. The journal has been selected as the official organ of the European Society of Pathology indicating appreciation of its tradition and quality in providing a forum for the exchange of scientific ideas.

Original international papers on subjects like molecular and ultrastructural pathology, pathochemistry, immunopathology, histopathology, cytology, macropathology, clinical pathology and pathophysiology, experimental pathology, and medicine contribute to the deepening of our current knowledge. The publication of reviews serves practical interests. In addition, particularly interesting individual cases are published in order to aid the world-wide exchange of practical experience.

Address: Gustav Fischer Verlag, P.O. Box 72 01 43, D-7000 Stuttgart 70



Gustav Fischer Verlag · Stuttgart · New York



C.R. MARÉS, S.A.

SUMINISTROS COMPLETOS PARA LABORATORIOS QUIMICOS
CLINICOS E INDUSTRIALES - ENSAYOS FISICOS - ELECTRONICA

CASA CENTRAL:
calle Valencia, 333
Teléfono 2576200
BARCELONA - 9

Delegación en Valencia:
Avenida Pérez Galdós, 91 - 93
Teléfonos 3260318 - 3260162
VALENCIA - 8

Casa Alvarez SRC

MATERIAL CIENTÍFICO

MAYOR, 65 - MADRID-13

TELEFONOS 248 05 27 Y 247 34 28

GENERAL REPRESENTATION FOR SPAIN OF:

WILD HEERBRUGG, Ltda. (Switzerland)

WILD
HEERBRUGG

: Stereomicroscopes
Photomicroscopes
Outfits for Photomicrography
Image converter

ERNST LEITZ WETZLAR GMBH (West Germany):



School laboratory and research microscopes
Outfits for Photomicrography and Photomicrography, Phase contrast, Interference contrast
Microscope photometers
Image analysis, semi and automatic
Microprojectors
Projectors for slides and solid specimens

REPRESENTATION FOR CATALUÑA AND BALEARES:

GERMAN RAMON CORTES

Consejo de Ciento, 366 Teléfono 318 17 00 BARCELONA -9 (Spain)

**Zeiss EM 109 —
the electron microscope with the
most up-to-date technology:
IGP for ideal vacuum,
TFP for better photo techniques and
MDF for optimum specimen protection.**

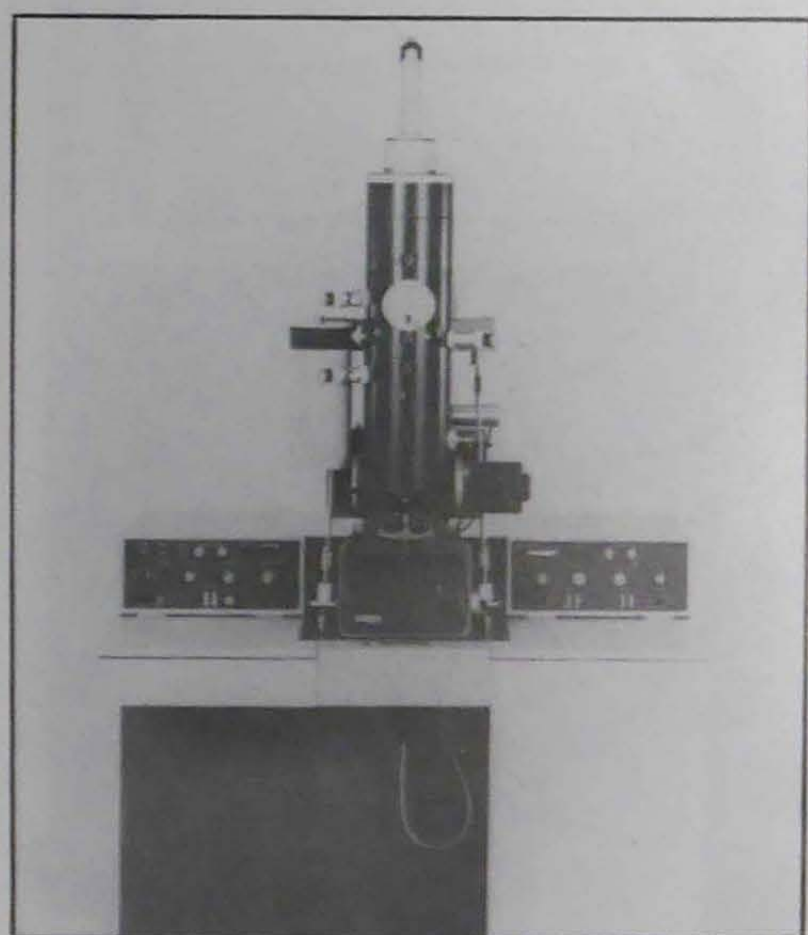

• Ion-Getter Pump: IGP
Unique oil-free pumping system. Avoids specimen contamination.

Trans Fiber-Optic Photography: TFP
Unique automated camera system. Totally outside the vacuum.

Micro-Dose Focusing: MDF
Unique automated focusing procedure saving your specimen.

Request detailed information
Carl Zeiss
D-7082 Oberkochen

Ultrathin section of rat liver 11,500x,
TFP camera

Point resolution better than 5 Å.
Lattice resolution 3.44 Å.
Magnification range 150x to 400,000x in 16 steps.
Expandable for special applications.

ZEISS

West Germany

Focus
on the future

Introducing The New Tissue-Tek[®] III V.I.P. Vacuum Infiltration Processor

A breakthrough in tissue processing

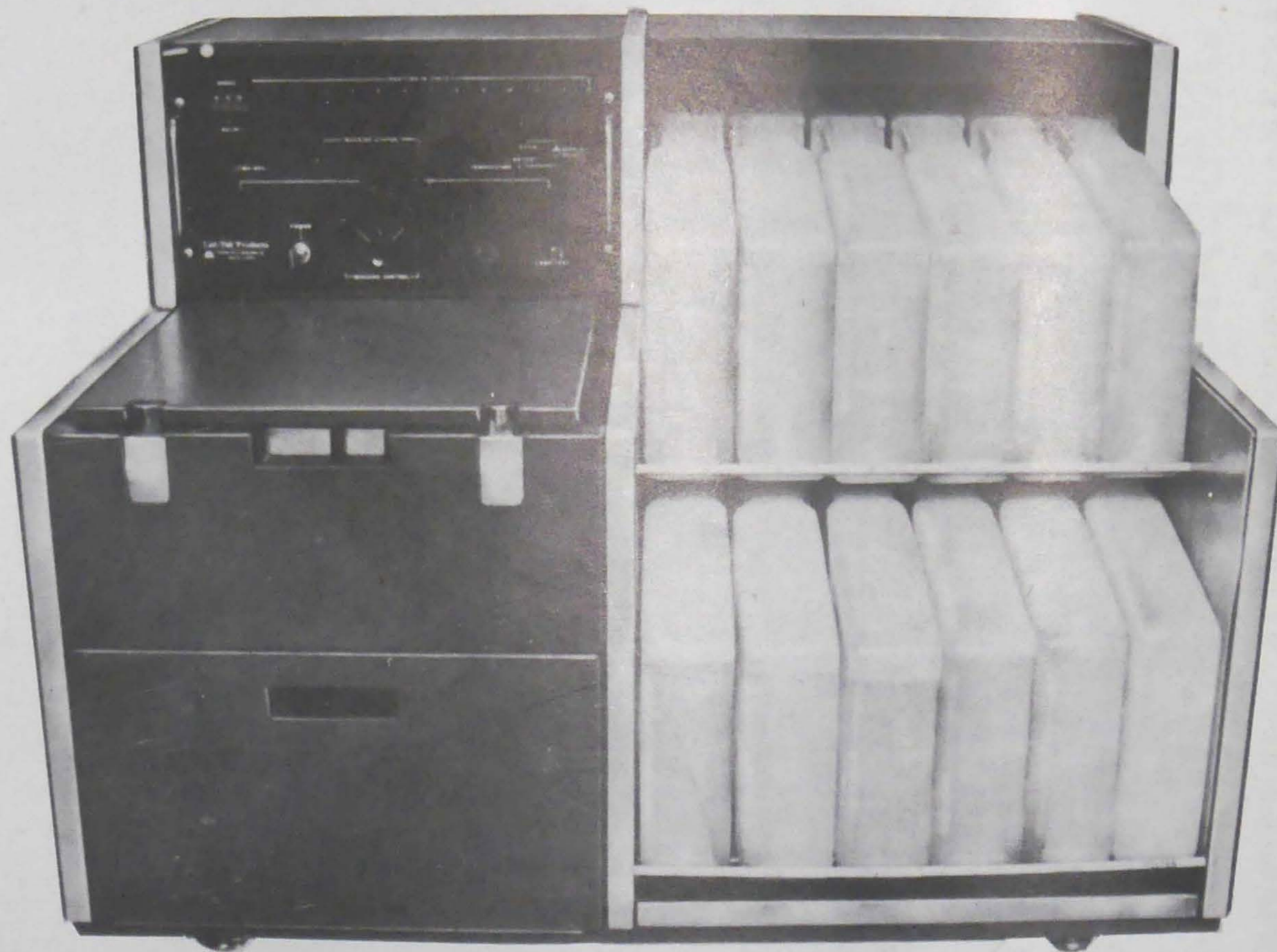

See the instrument in operation
at our booth no. 6 & 7 in the
Congress Exhibition.

Lab-Tek Products
MILES DIVISION MILES LABORATORIES, INC.

Lab-Tek Products . . . setting the standards by which performance is judged.

En España Lab-Tek es una División de Miles Martin Laboratorios, S.A.E. - Plaza de España, 10 - Madrid-13.

